

Architecture  
Interior Design  
Landscape Architecture  
Planning  
Urban Design

Australia  
China  
Hong Kong SAR  
Singapore  
Thailand  
United Kingdom

# AMP CIRCULAR QUAY PRECINCT MASTER PLAN\_ ADDITIONAL SHADOW AND SUN ACCESS REPORT

Prepared for AMP Capital  
18 December 2012

HASSELL

AMPCAPITAL 

**Contact**

**Matthew Pullinger** Principal  
mpullinger@hassellstudio.com

HASSELL  
Level 2  
88 Cumberland Street  
Sydney NSW  
Australia 2000  
T +61 2 9101 2000  
© December 2012

**INTRODUCTION** 1

**EXECUTIVE SUMMARY** 3

**SHADOW AND SUN ACCESS STUDY** 7

14 April  
21 June  
31 August



## Introduction

**This shadow and sun access report has been prepared for AMP Capital in support of a formal request to the City of Sydney for an amendment to the Sydney LEP 2012 (SLEP) and Sydney DCP 2012 (DCP) and forms part of the Planning Justification Report submission for the AMP Circular Quay Precinct. The shadow and sun access report should be read in conjunction with the urban design report.**

The proposed amendments to the SLEP and DCP seek to facilitate a significant redevelopment of the AMP Circular Quay Precinct by transferring a notional floor space entitlement from the Young and Loftus block to the Bridge and Alfred Street block. This transfer of floor space from a constrained site to another more able to accommodate it will enable a significant transformation, reinforcing the economic viability and amenity of one of the key parts of the city.

### The Precinct

The AMP Circular Quay Precinct is made up of the area bounded by Loftus, Bridge, Phillip and Alfred Streets (but excluding land to the north of Customs House Lane and south of the east-west leg of Loftus Lane), it comprises the following buildings under the control of AMP Capital Investors:

- The Bridge and Alfred Block**
  - 50 Bridge Street Tower (AMP Centre)
  - 33 Alfred Street Tower (Sydney Cove Local heritage listed)
- The Young and Loftus Block**
  - 5-7 Young Street (Hinchliff House, State heritage listed)
  - 9-13 Young Street
  - 15-17 Young Street
  - 2-10 Loftus Street (AMP General House)
  - 12 Loftus Street (Gallipoli Club, Local heritage listed)
  - 20 Loftus Street

### Proposed Built Form Envelope

The overshadowing studies contained within this report illustrate the shadowing impact of the maximum proposed built form envelope. The proposed built form envelope documents the geometric envelope achievable within the constraints of the site.

### Methodology

The overshadowing studies contained within this report have been produced by HASSELL using 3D Studio Max, and have been based on the following base information (see appendix):

- City model supplied by the City of Sydney, including city buildings and topography (The supplied model has an accuracy of +/- 300mm)
- Survey Drawings prepared by Denny Linker & Co:
  - \_ Plan showing detail and levels at First Government House Place and Macquarie Place Park (22/10/2012)
  - \_ Plan showing elevations Young Street & Loftus Street (20/07/2012)
- Survey Drawings prepared by Frank M Mason & Co:
  - \_ Plan showing spot levels and features over AMP property between Young and Loftus Streets (22/02/2001)
- Survey Drawings prepared by PSN:
  - \_ Sections showing typical structure north-south
  - \_ Plan showing location of buildings and structures at 50 Bridge Street (Sheet 1)
  - \_ Plan showing location of buildings and structures at 50 Bridge Street (Sheet 2)
- The proposed master plan has been based on solar access envelopes described in the 'Solar Impact Report' by PSN/Matter (12/09/2011)

The shadow studies contained within this report are accurate to the implied limits of the supplied base information. HASSELL does not accept responsibility for the accuracy of this base information.









## Executive Summary

By adopting a precinct-wide approach to the redistribution of floor space the master plan seeks to transfer the unrealised floor space from the Young and Loftus block to the Bridge and Alfred block.

The lower scaled Young and Loftus buildings will provide an increase in morning sunlight to Macquarie Place in mid winter, with the transferred floor space being accommodated within an extension to the 50 Bridge Street tower which whilst projecting through the Botanic Gardens sun access plane does so in a way that ensures no additional overshadowing to the Botanic Gardens at the control time of 2pm on 21st June.

A summary of the shadow and sun access analysis is as follows:

### First Government House Place

- \_No additional overshadowing of First Government House place.
- \_A modest net increase in solar access in mid winter has been achieved by offsetting a small (20 m<sup>2</sup>) additional shadow at 12pm with a (30 m<sup>2</sup>) improvement in solar access at 2pm.
- \_See appendix A for detailed study.







14 April



Shadow and Sun Access Study

First Government House Place

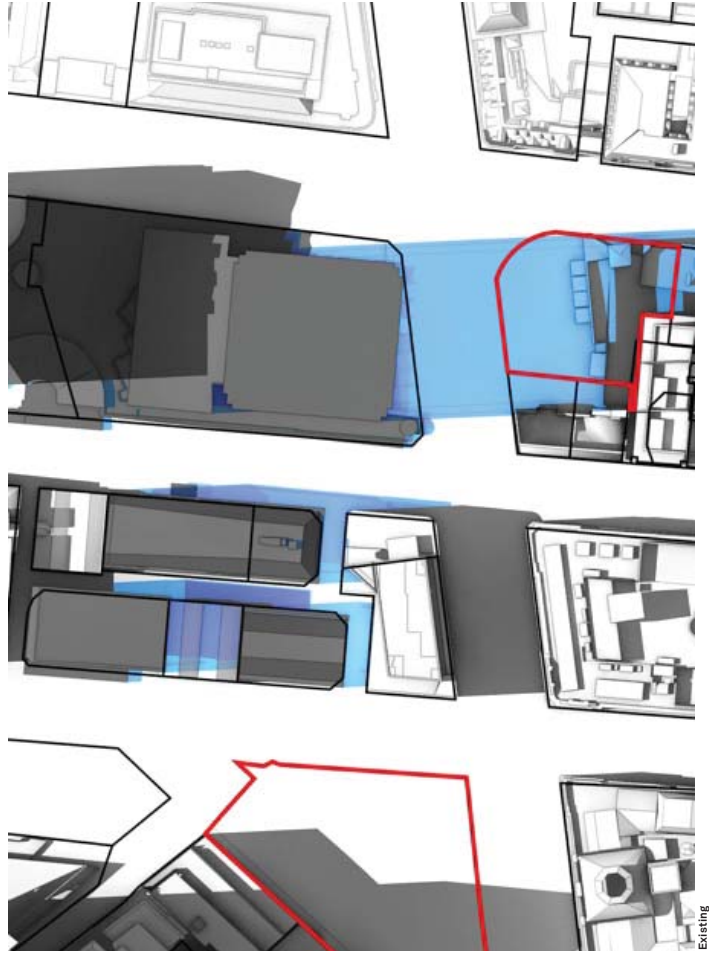

Legend

- Existing situation
- Proposed envelope



Time 12:00 pm

Date 14 April

Shadow and Sun Access Study

First Government House Place

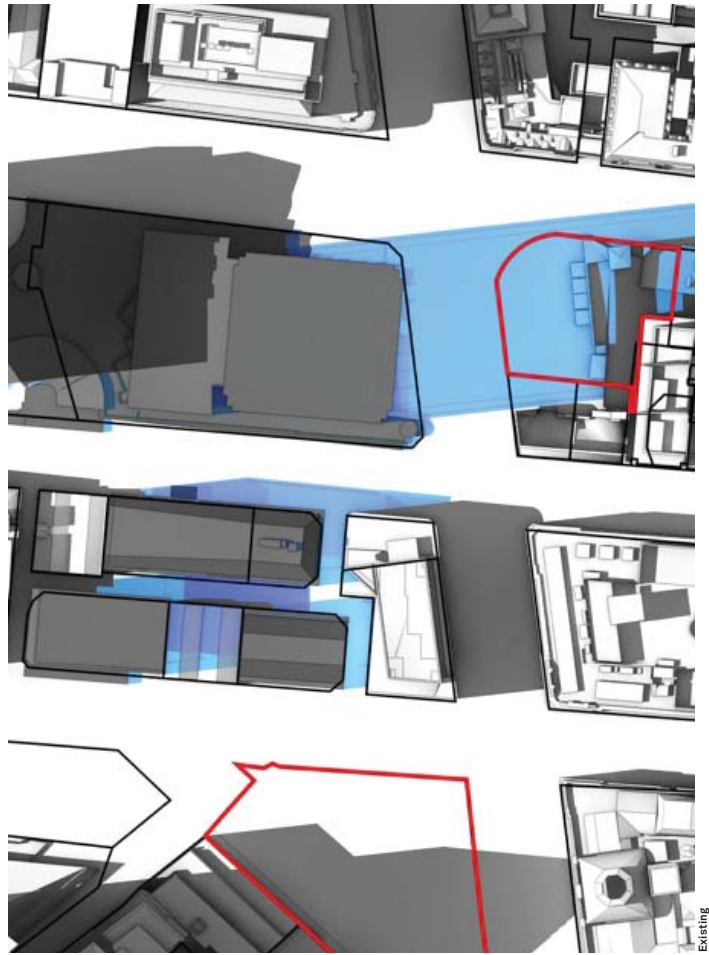

Legend

- Existing situation
- Proposed envelope



Time  
12:10 pm

Date  
14 April



Shadow and Sun Access Study

First Government House Place

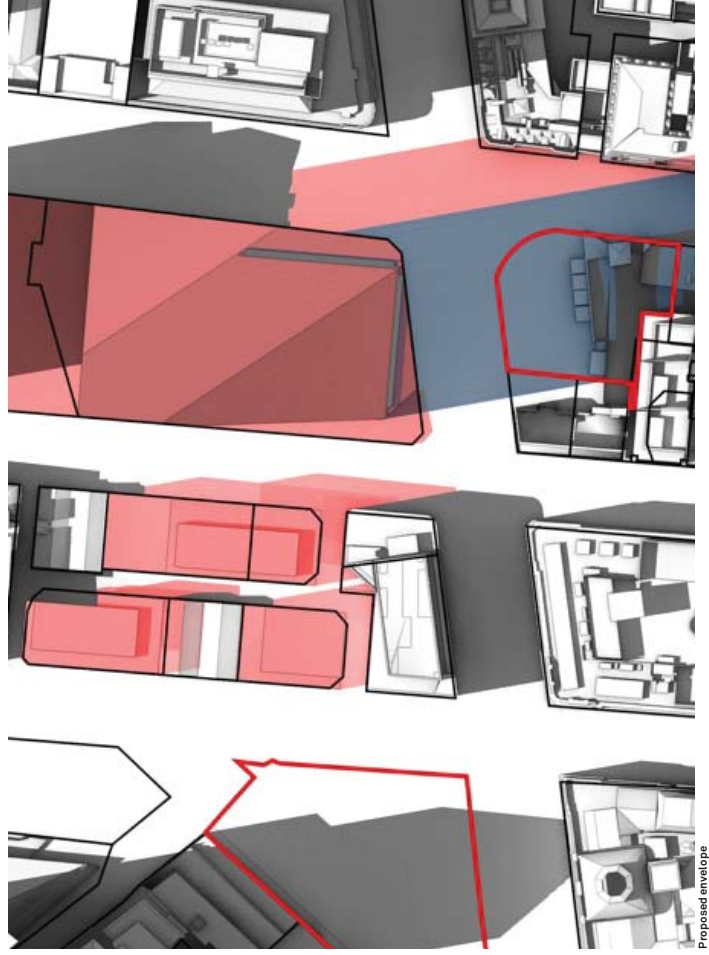
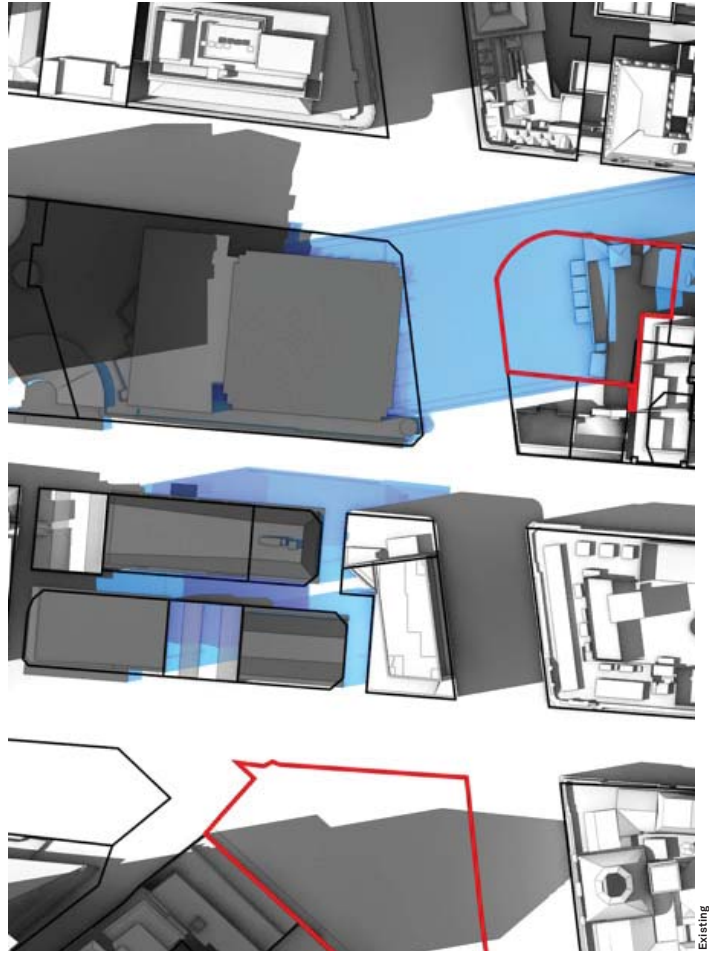

Legend

- Existing situation
- Proposed envelope



Time 12:20 pm

Date 14 April

Shadow and Sun Access Study

First Government House Place

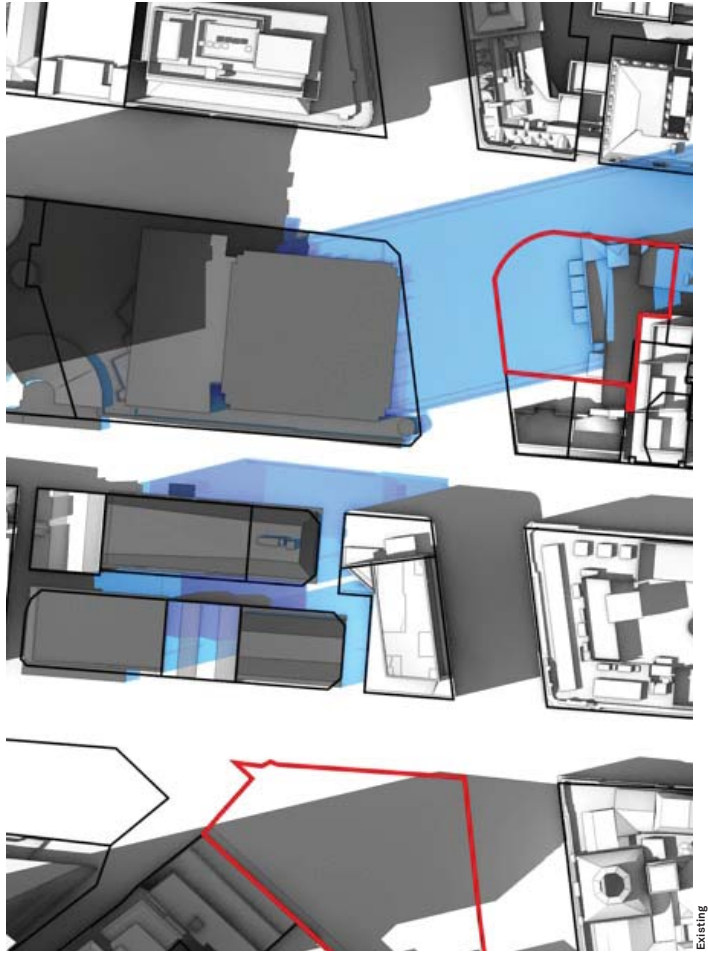

Legend

- Existing situation
- Proposed envelope



Time  
12:30 pm

Date  
14 April

Shadow and Sun Access Study

First Government House Place

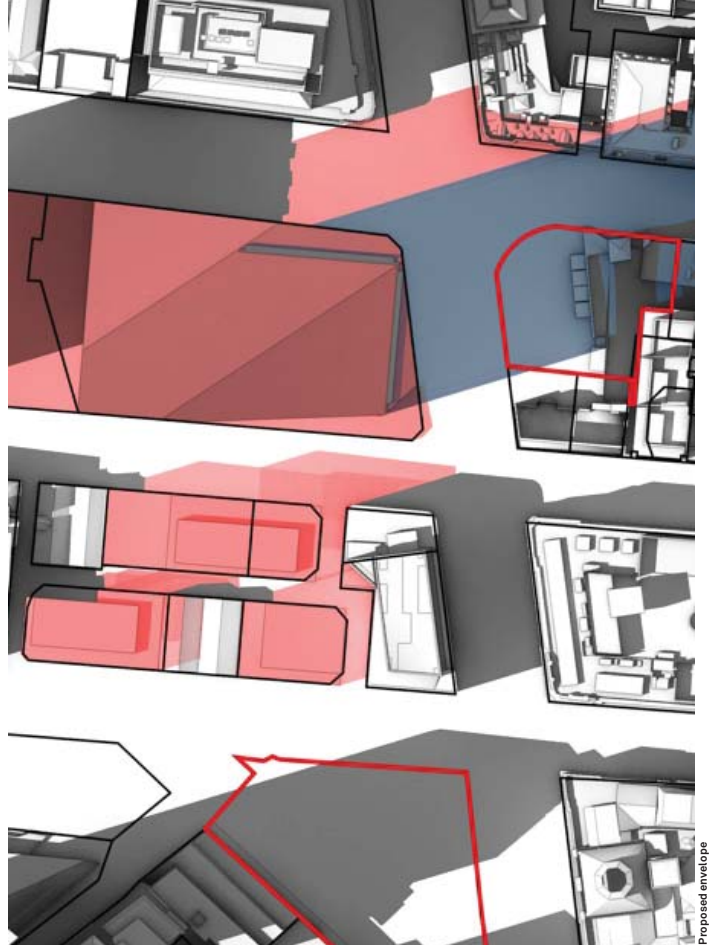
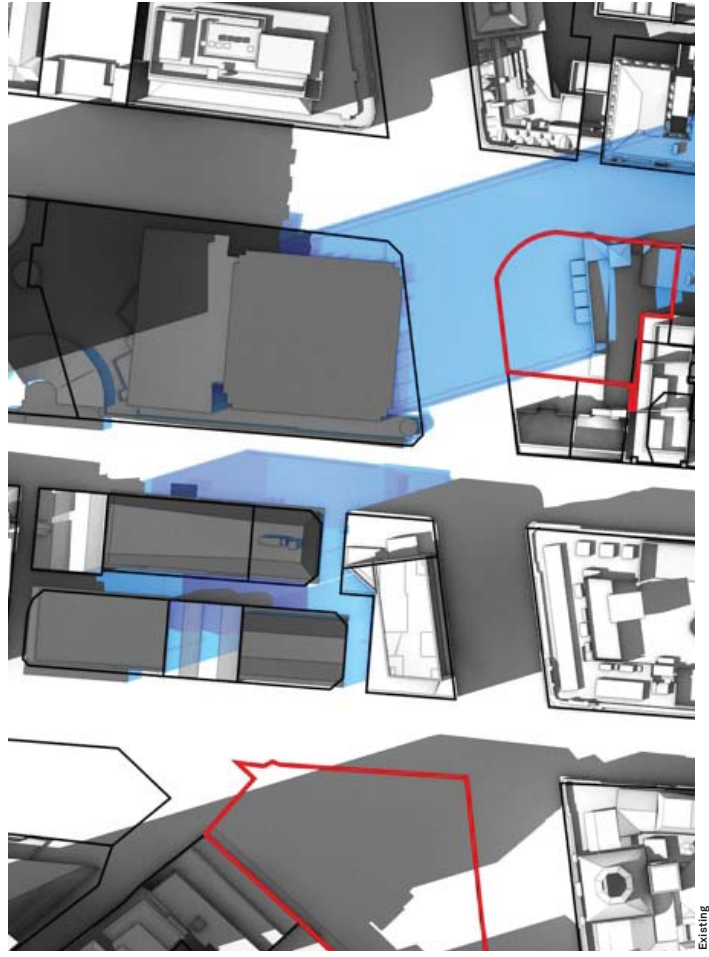

Legend

- Existing situation
- Proposed envelope



Time 12:40 pm

Date 14 April

Shadow and Sun Access Study

First Government House Place

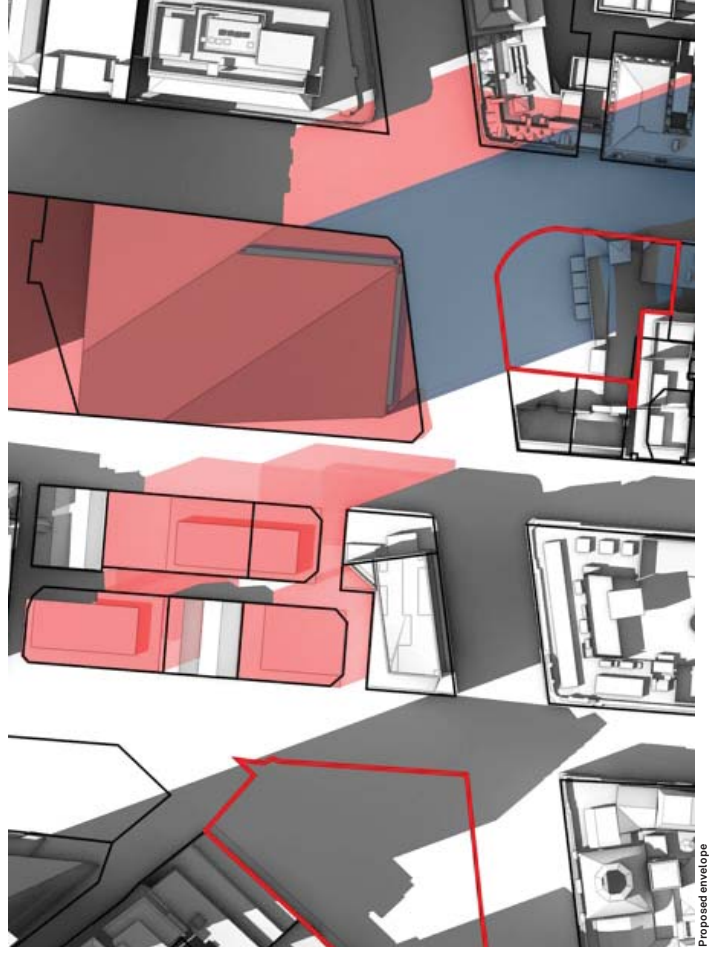
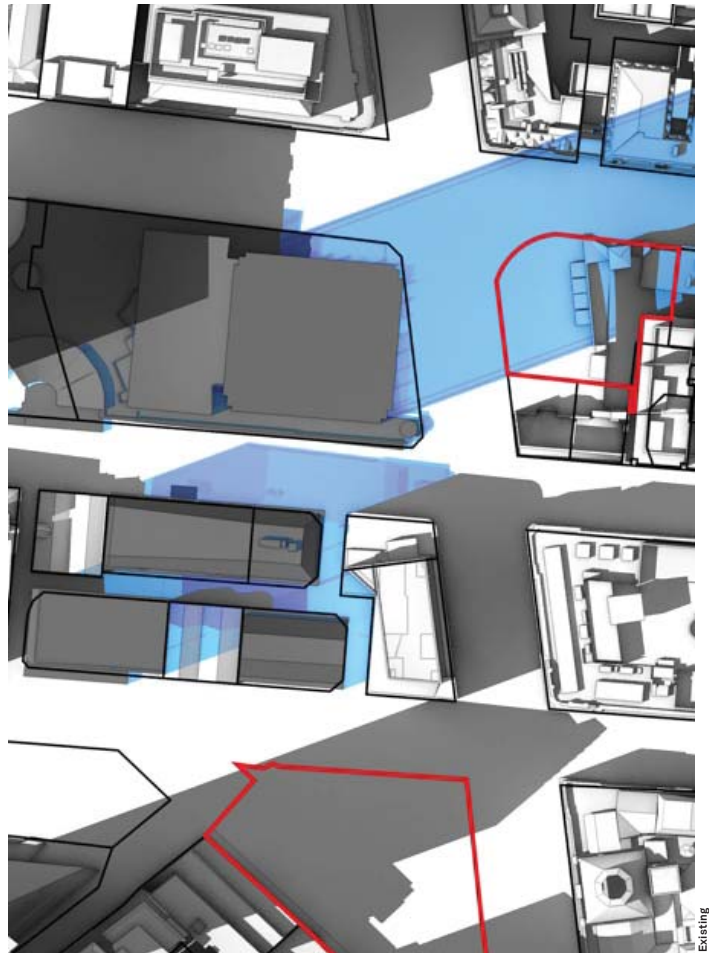

Legend

- Existing situation
- Proposed envelope



Time  
12:50 pm

Date  
14 April

Shadow and Sun Access Study

First Government House Place

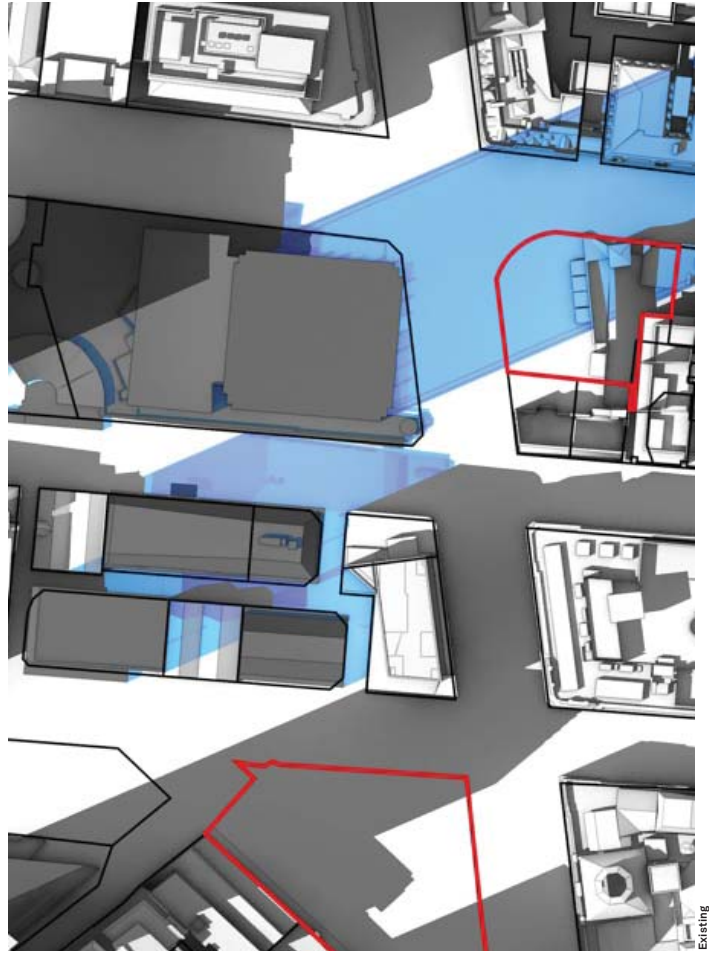

Legend

- Existing situation
- Proposed envelope



Time  
01:30 pm

Date  
14 April

Shadow and Sun Access Study

First Government House Place

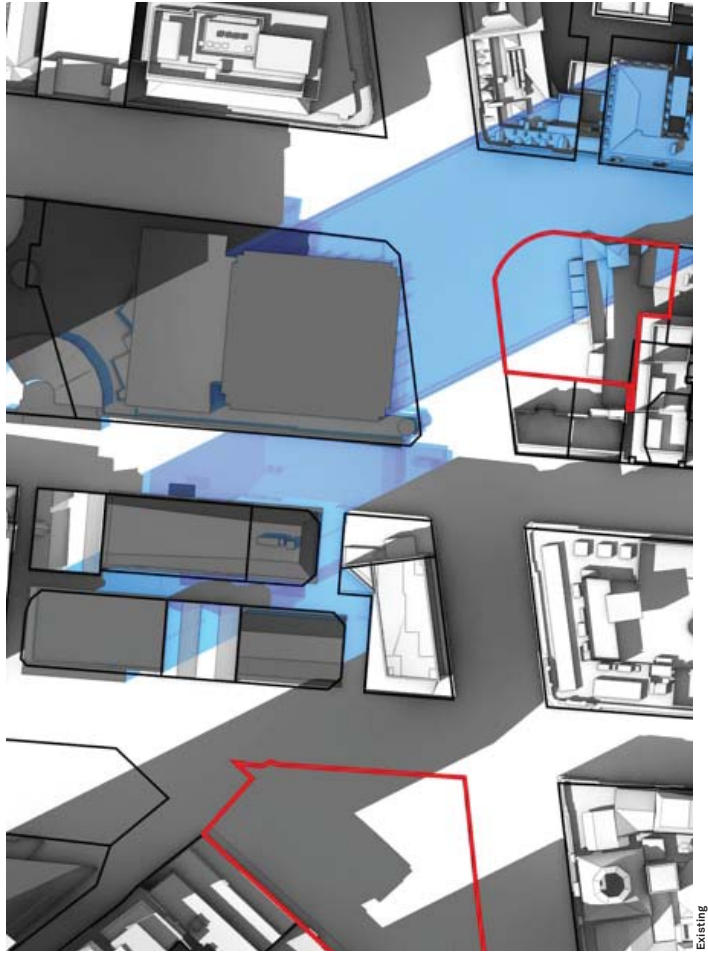

Existing

Legend

- Existing situation
- Proposed envelope

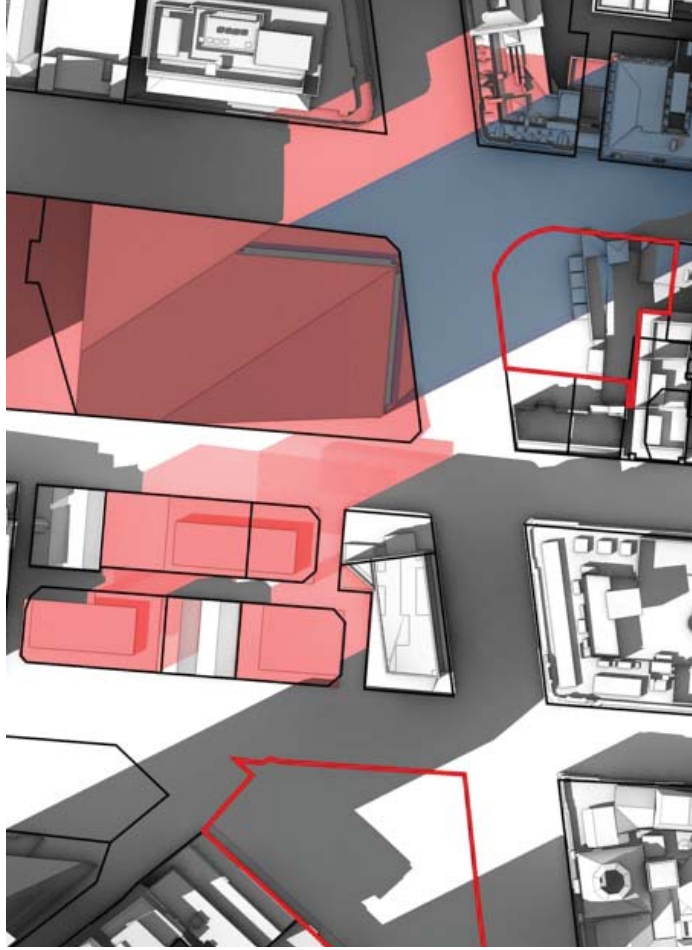

Proposed envelope



Time  
01:10 pm

Date  
14 April

Shadow and Sun Access Study

First Government House Place

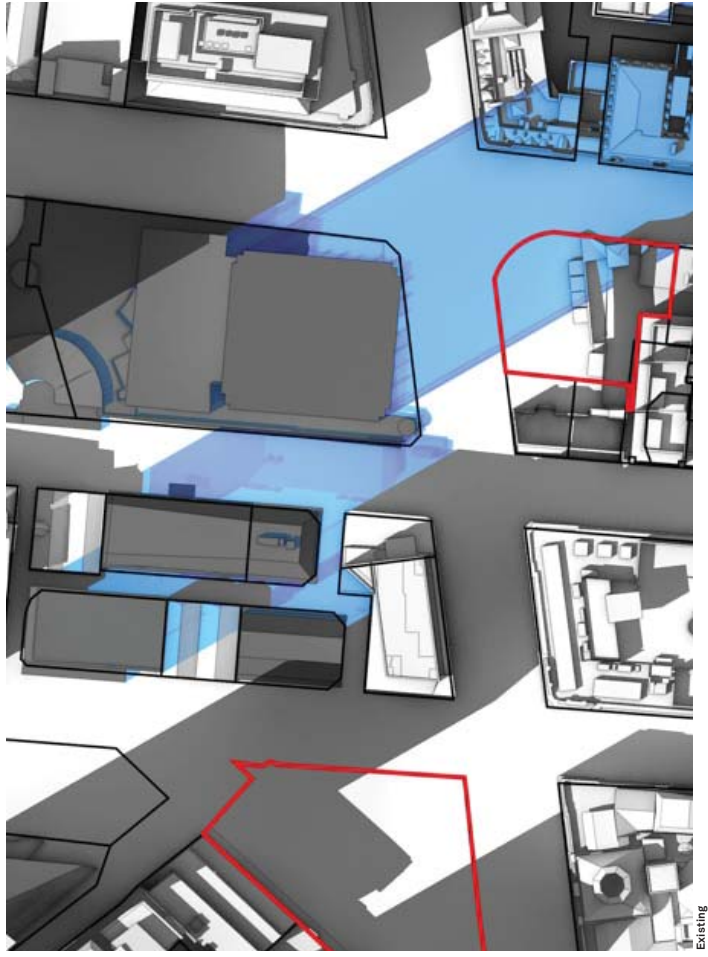

Legend

- Existing situation
- Proposed envelope

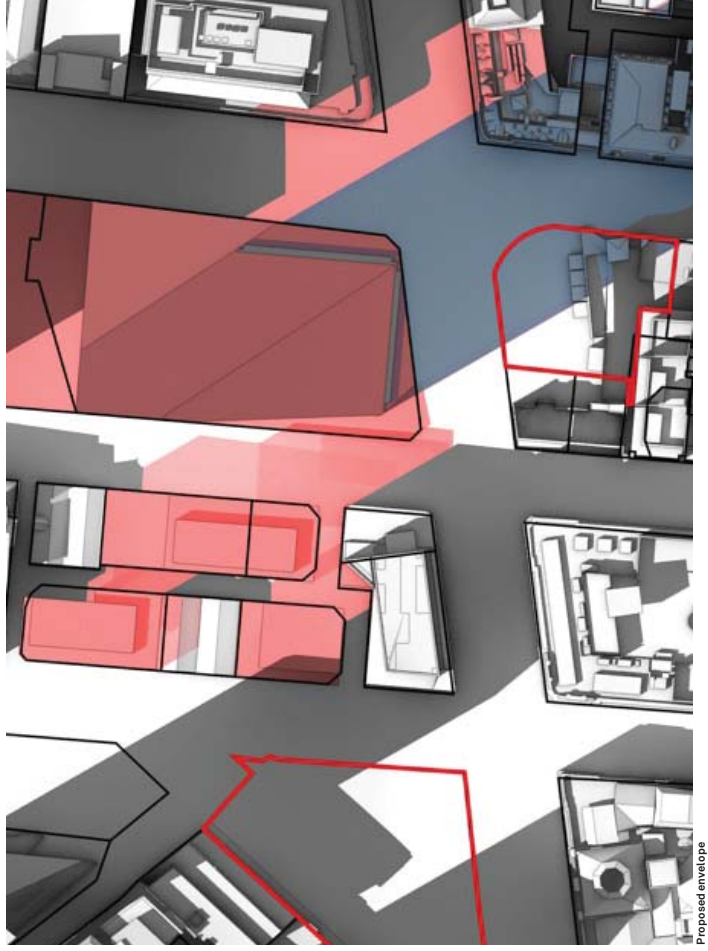

Proposed envelope



Time 01:20 pm

Date 14 April

Shadow and Sun Access Study

First Government House Place

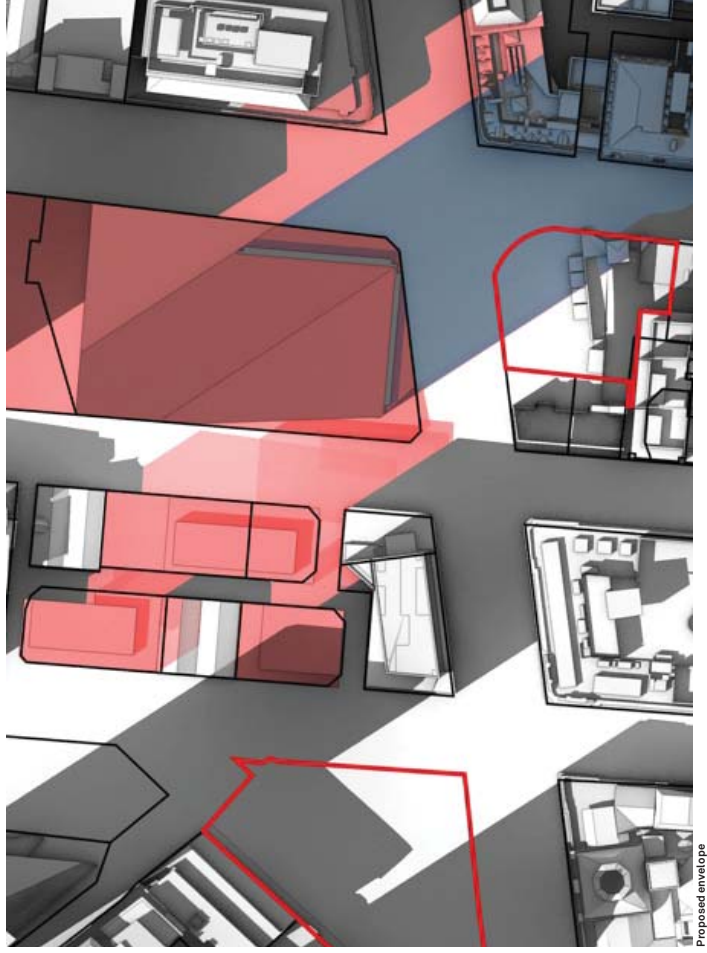
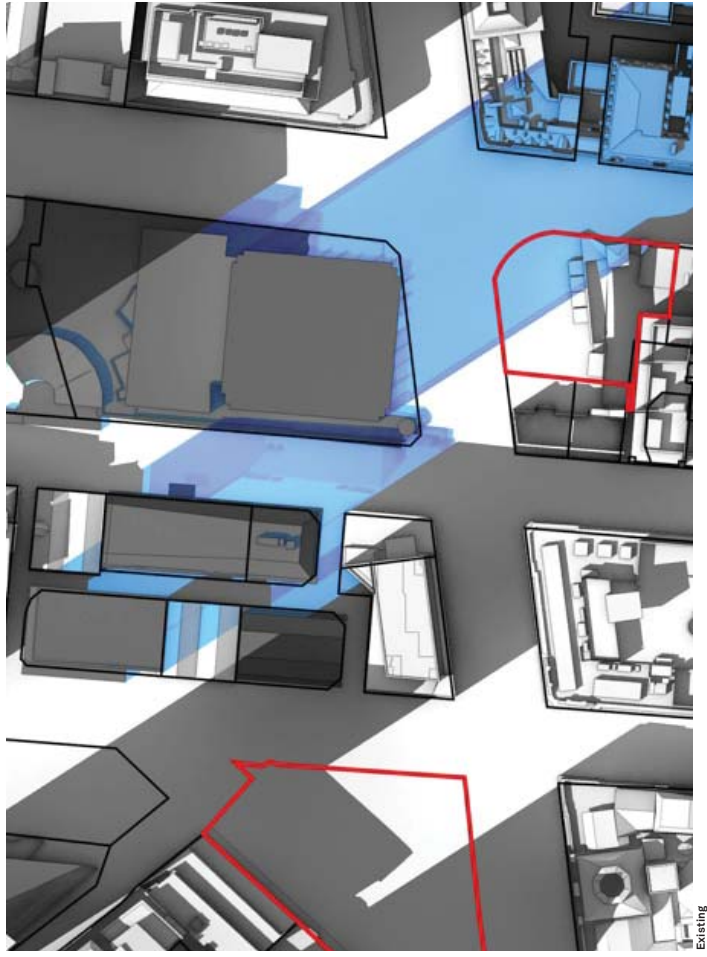

Legend

- Existing situation
- Proposed envelope



Time 01:30 pm

Date 14 April



Shadow and Sun Access Study

First Government House Place

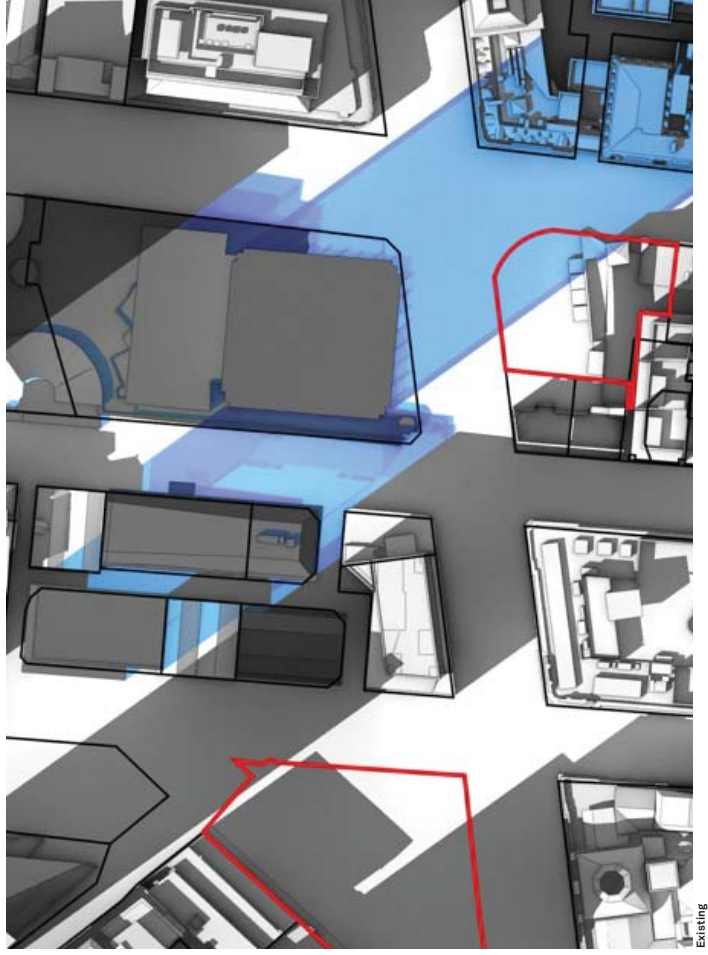

Legend

- Existing situation
- Proposed envelope

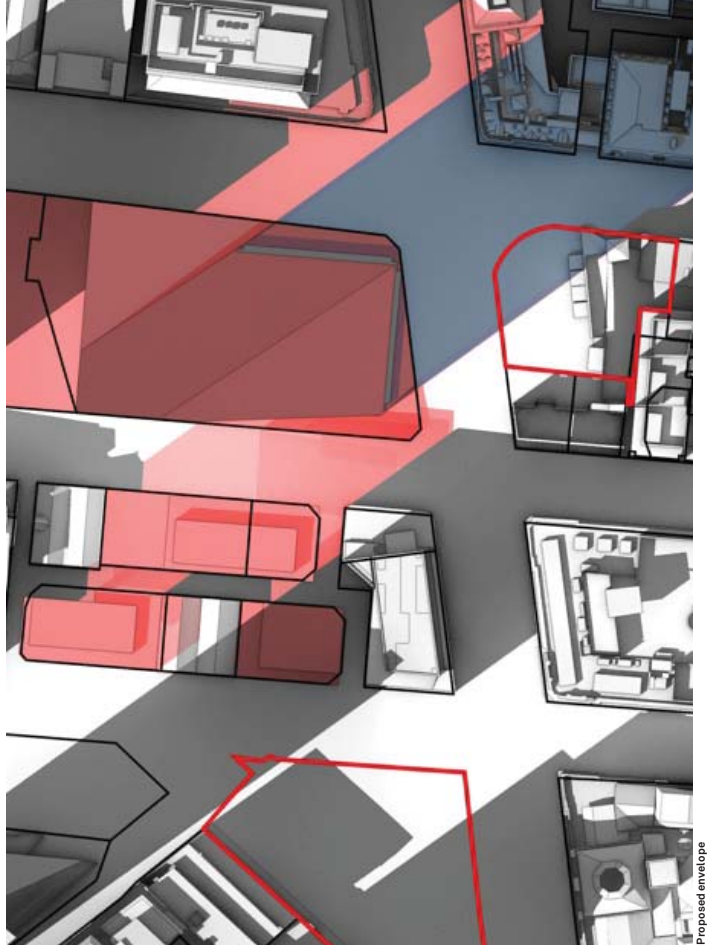

Time 01:40 pm

Date 14 April

Shadow and Sun Access Study

First Government House Place

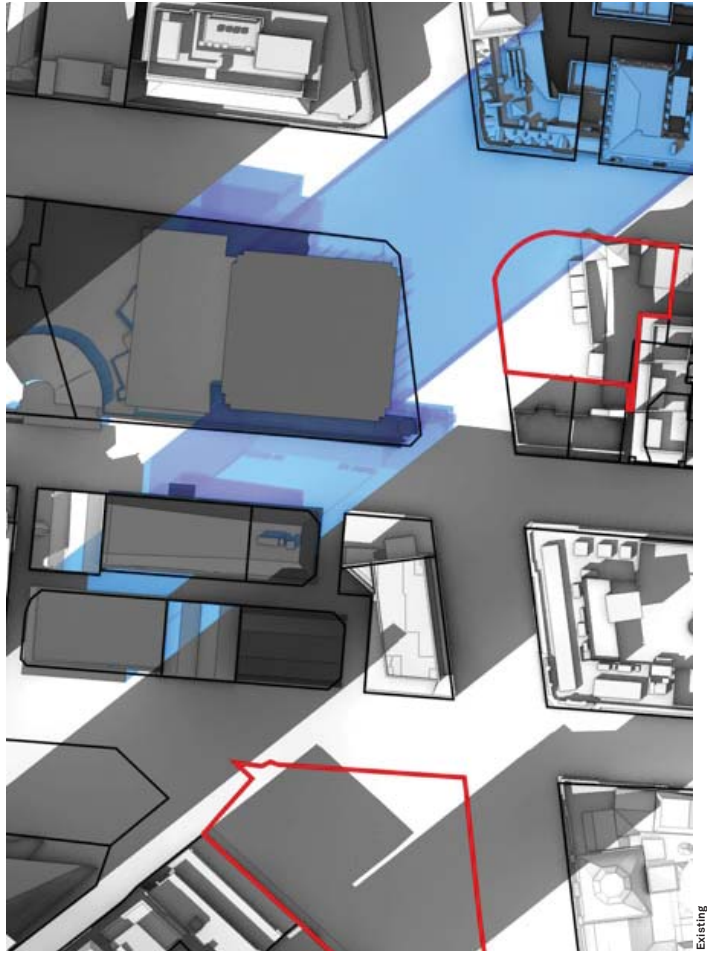

Legend

- Existing situation
- Proposed envelope

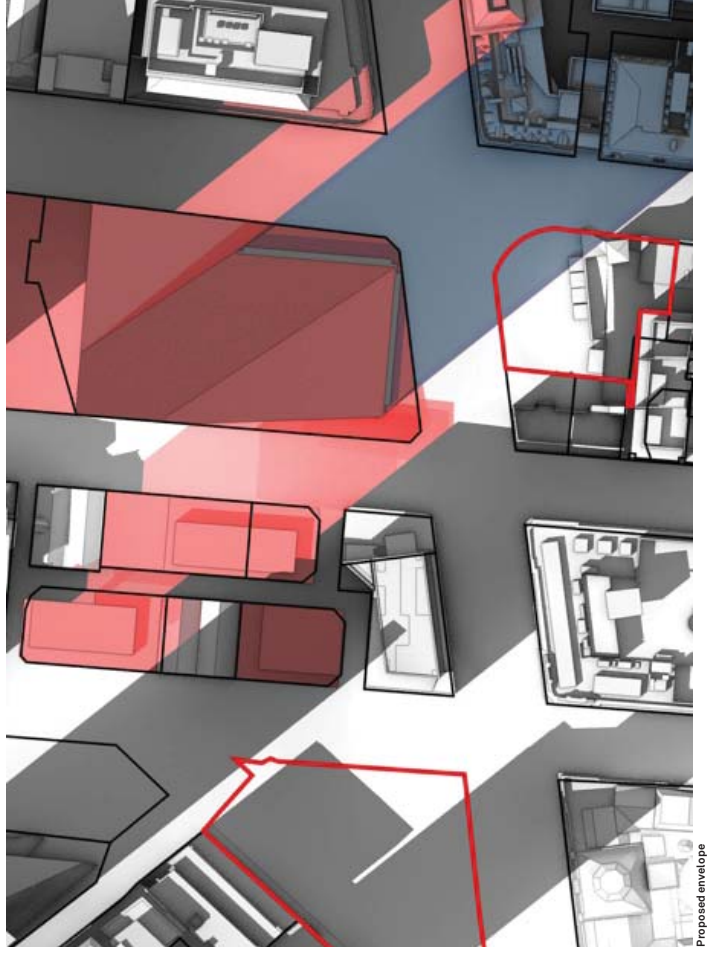

Time  
01:50 pm

Date  
14 April

Shadow and Sun Access Study

First Government House Place

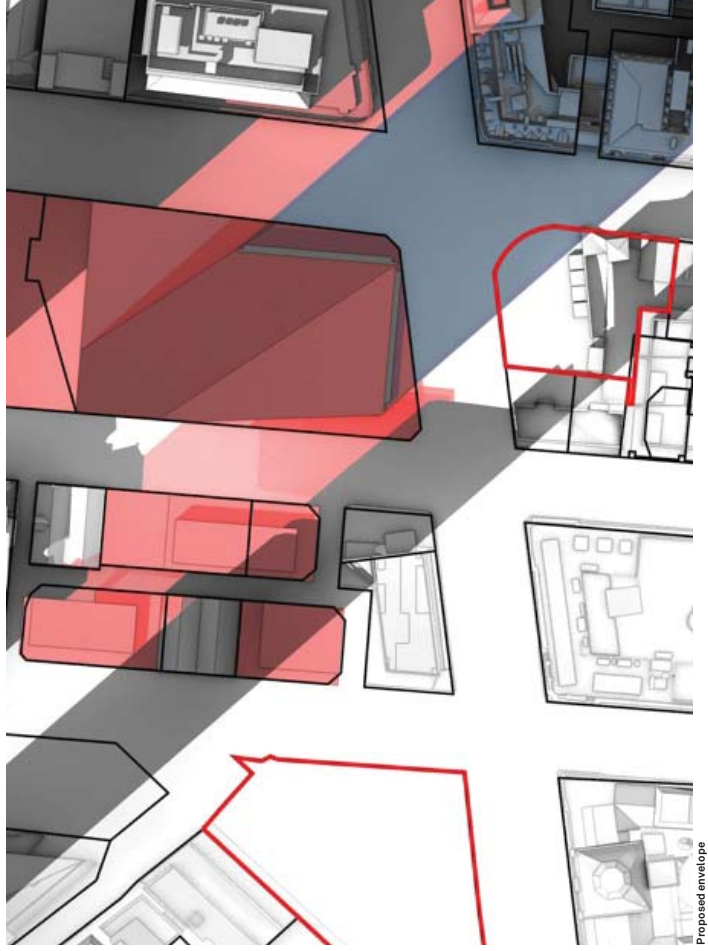
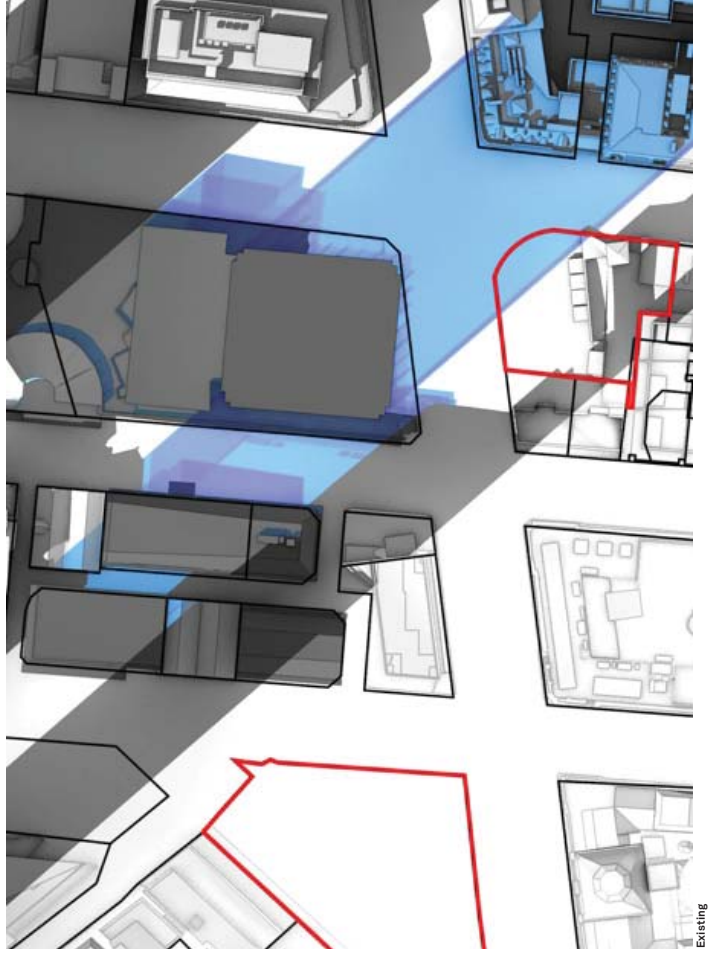

Legend

- Existing situation
- Proposed envelope



Time 02:30 pm

Date 14 April



21 June



Shadow and Sun Access Study

First Government House Place

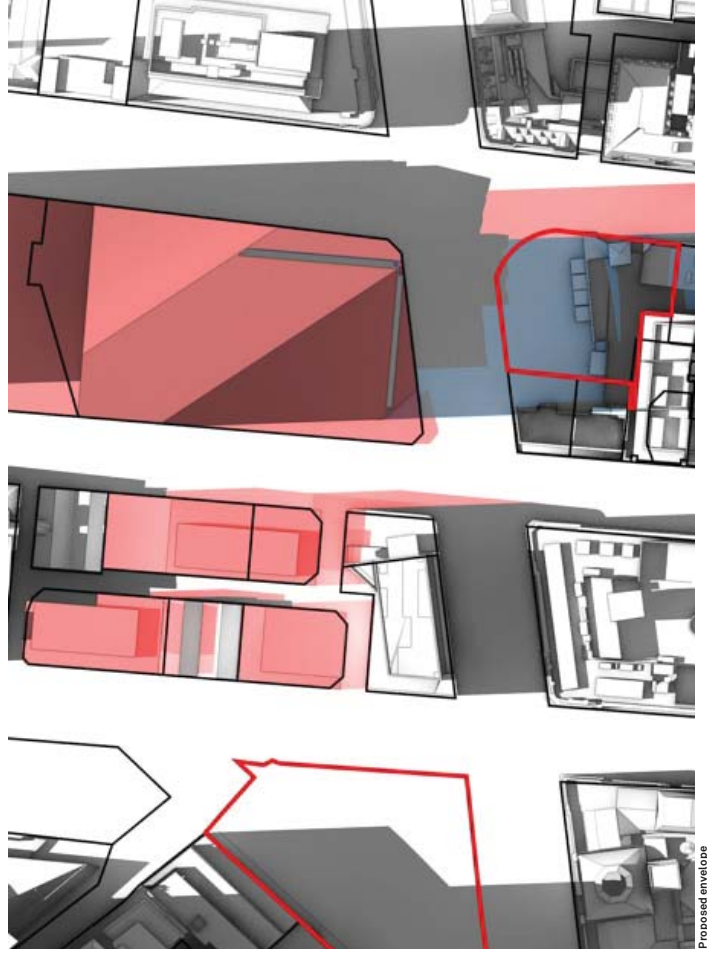
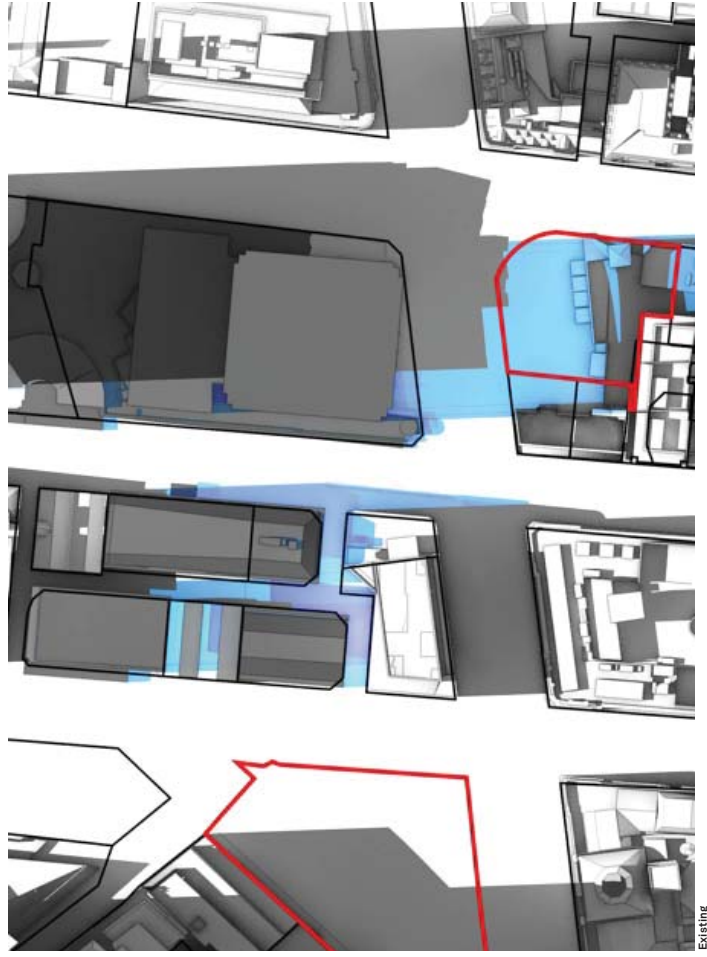

Legend

- Existing situation
- Proposed envelope



Time 12:00 pm

Date 21 June

Shadow and Sun Access Study

First Government House Place

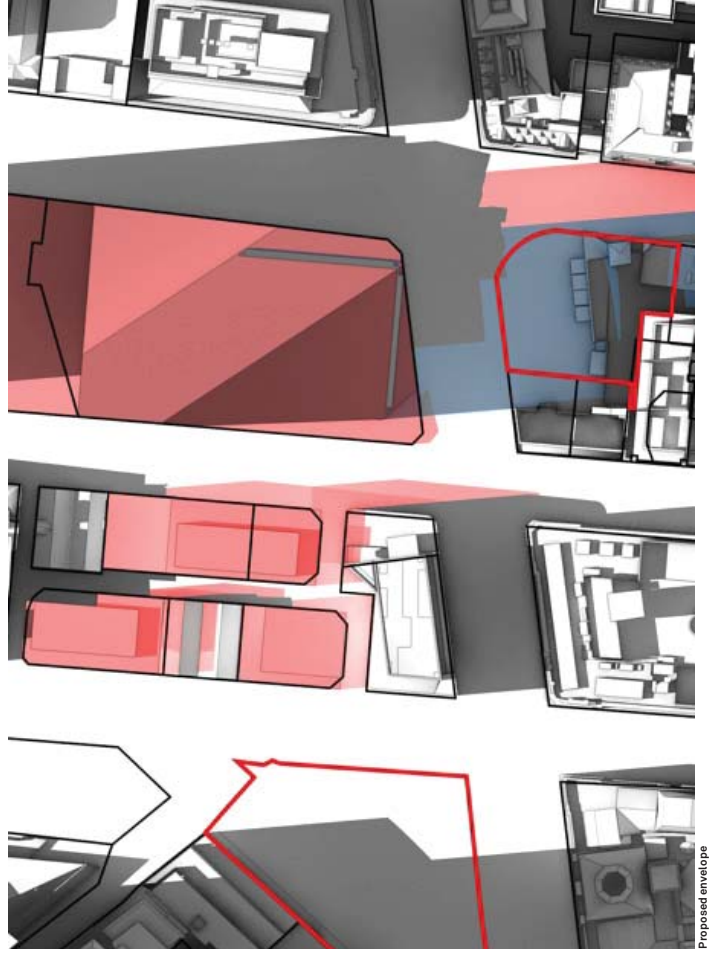
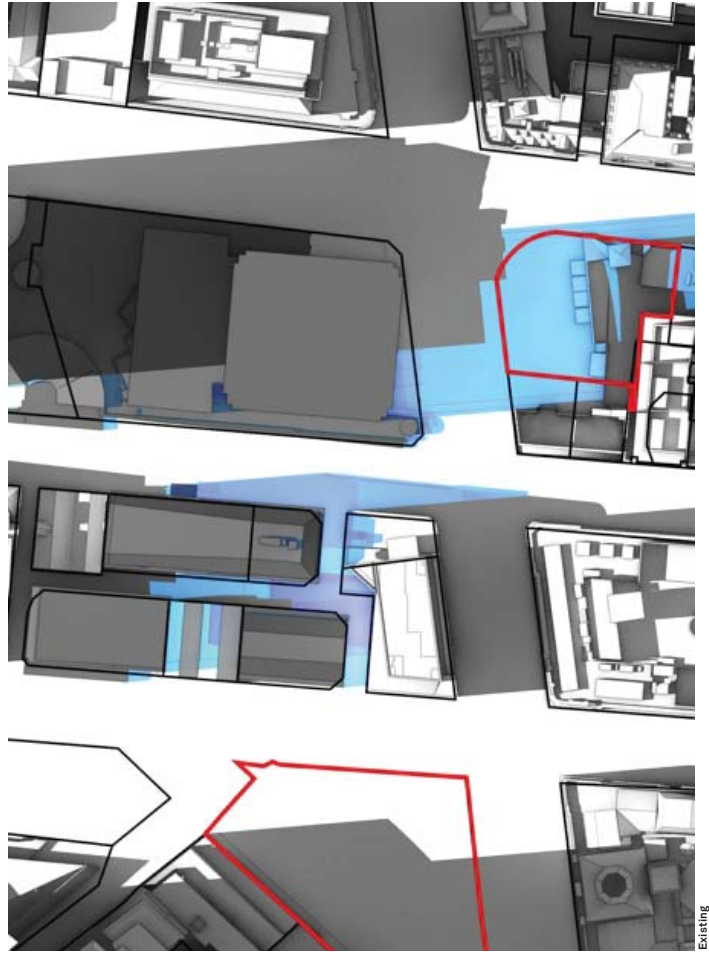

Legend

- Existing situation
- Proposed envelope



Time  
12:10 pm

Date  
21 June



Shadow and Sun Access Study

First Government House Place

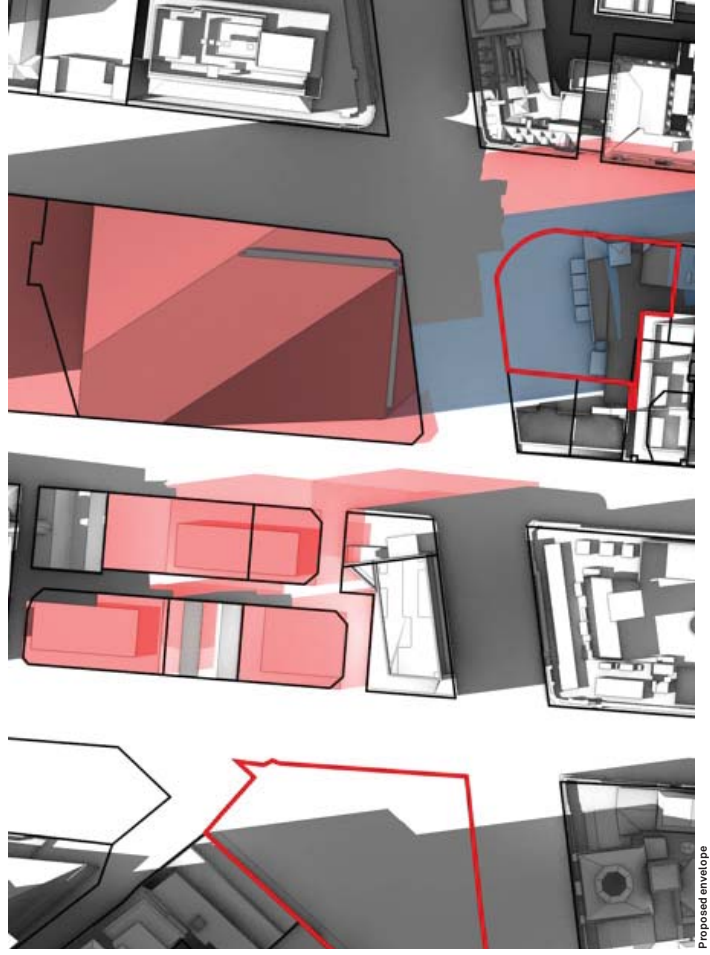
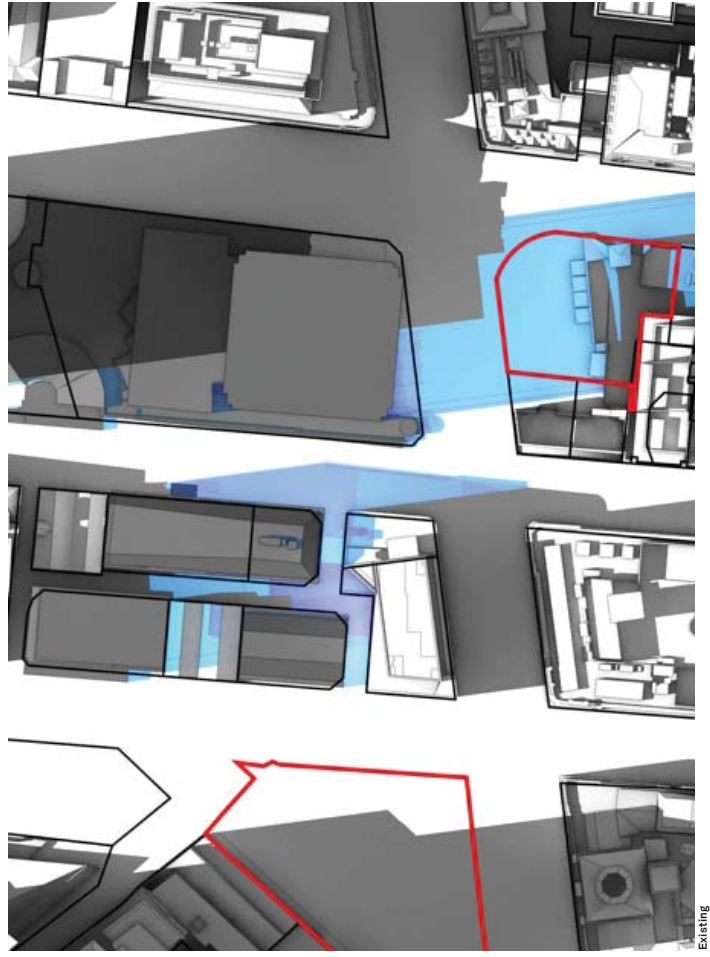

Legend

- Existing situation
- Proposed envelope



Time 12:20 pm

Date 21 June

Shadow and Sun Access Study

First Government House Place

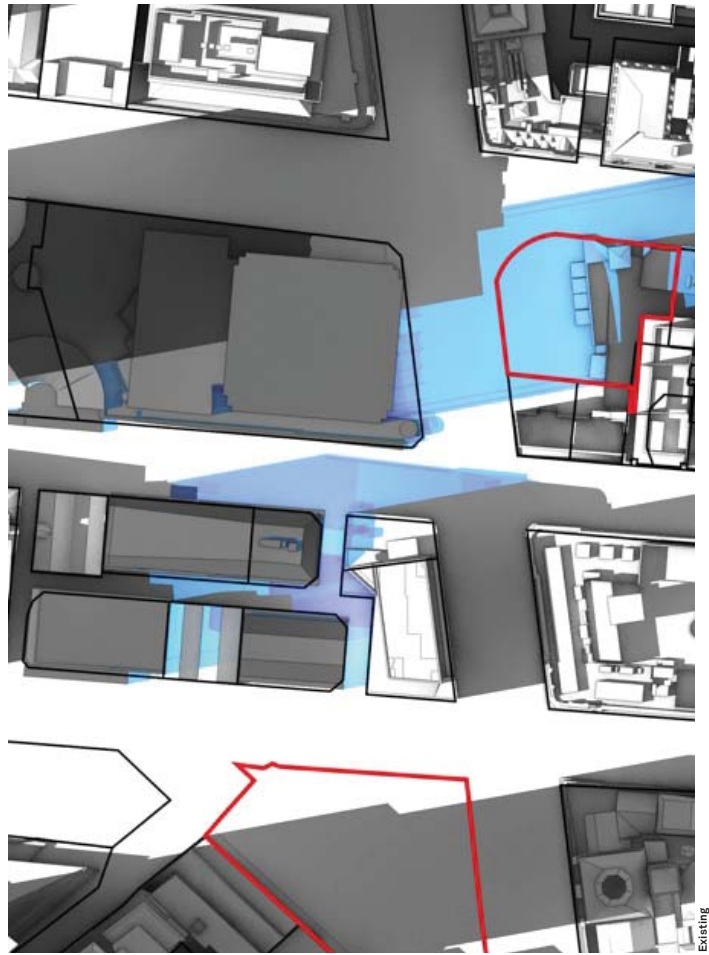

Legend

- Existing situation
- Proposed envelope



Time  
12:30 pm

Date  
21 June

Shadow and Sun Access Study

First Government House Place

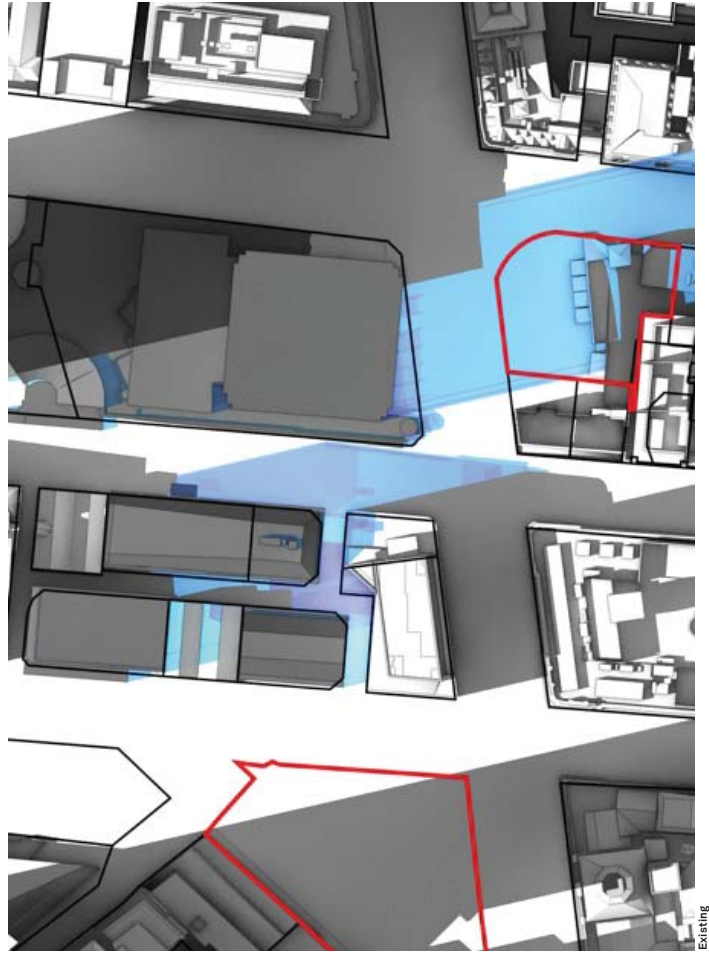

Legend

- Existing situation
- Proposed envelope



Time 12:40 pm

Date 21 June

Shadow and Sun Access Study

First Government House Place

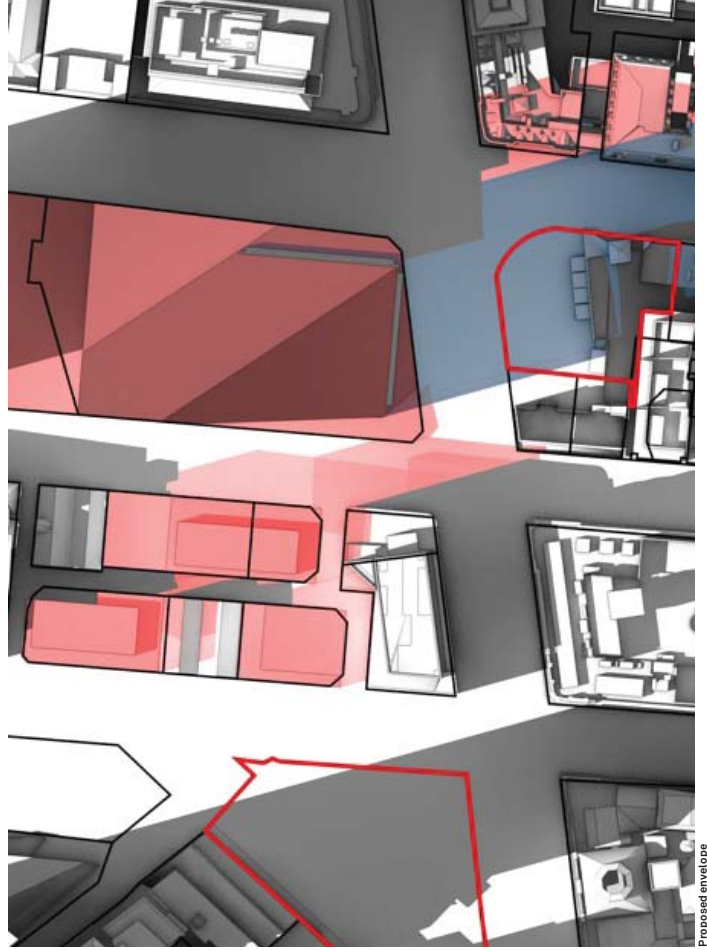

Legend

- Existing situation
- Proposed envelope



Time  
12:50 pm

Date  
21 June

Shadow and Sun Access Study

First Government House Place

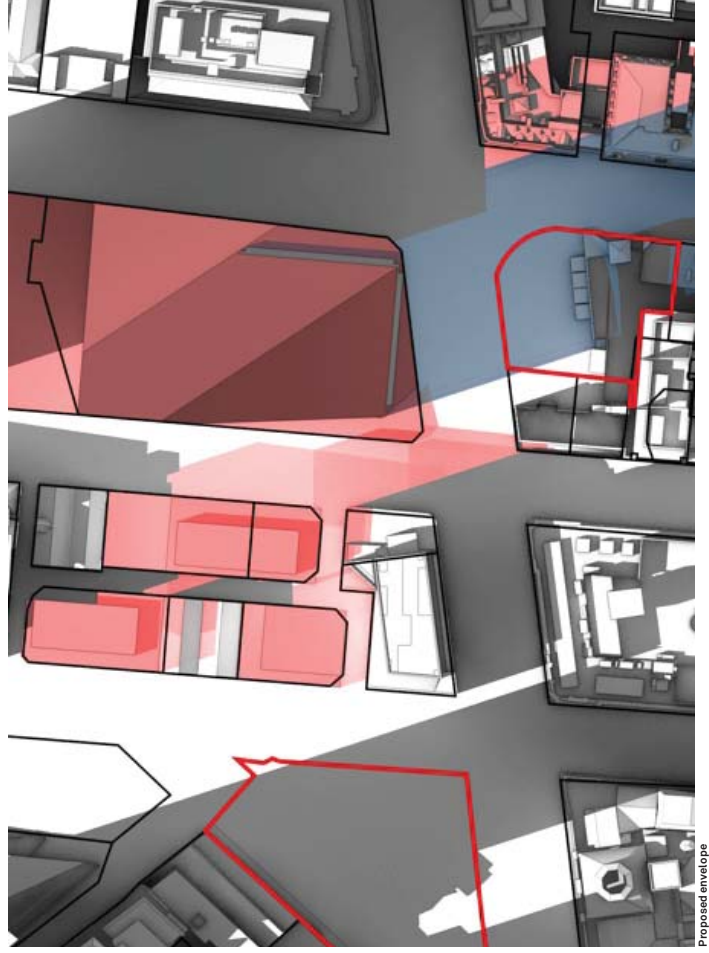
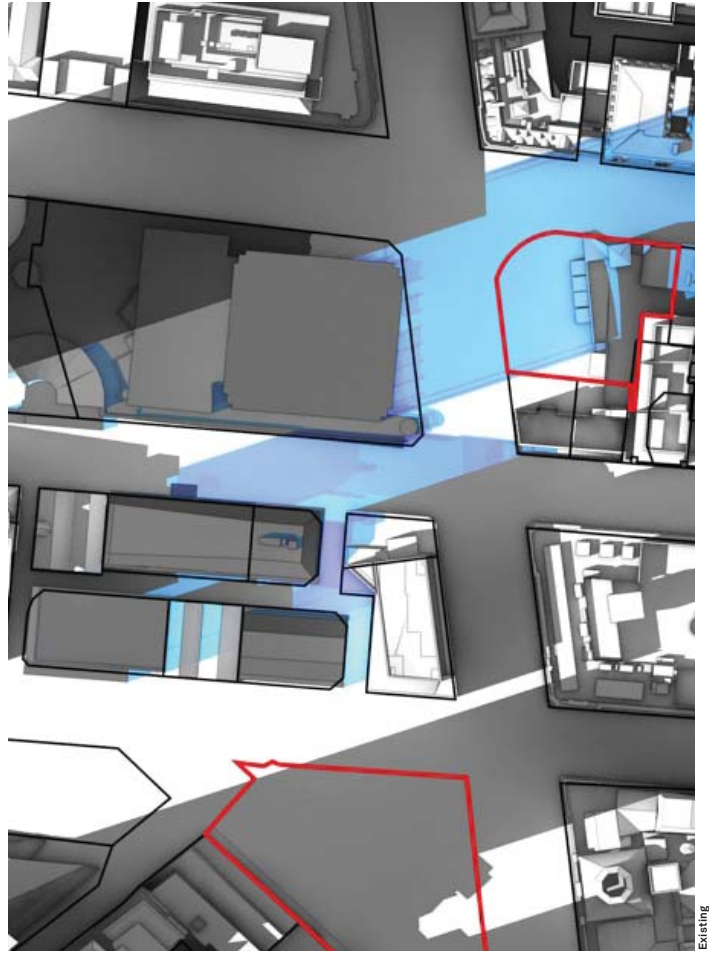

Legend

- Existing situation
- Proposed envelope



Time 01:00 pm

Date 21 June

Shadow and Sun Access Study

First Government House Place

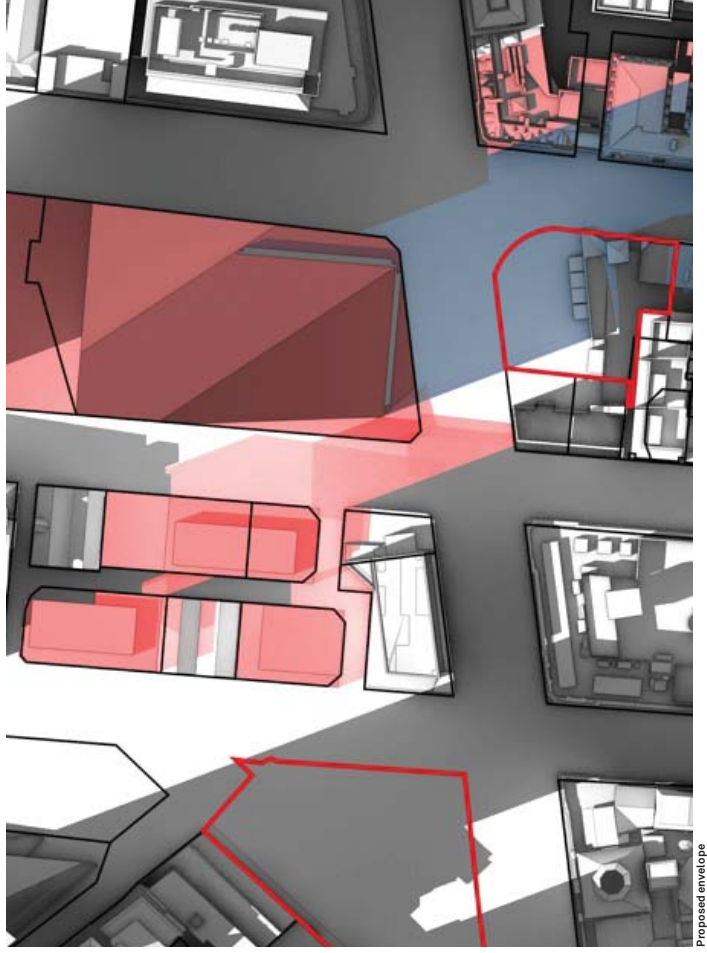
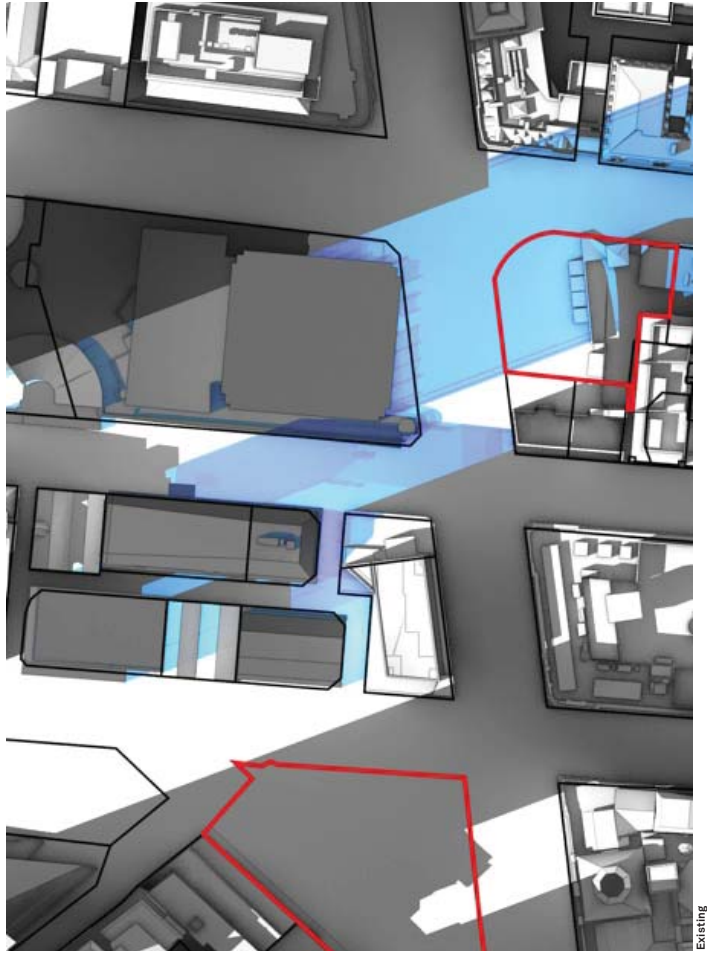

Legend

- Existing situation
- Proposed envelope



Time 01:10 pm

Date 21 June

Shadow and Sun Access Study

First Government House Place

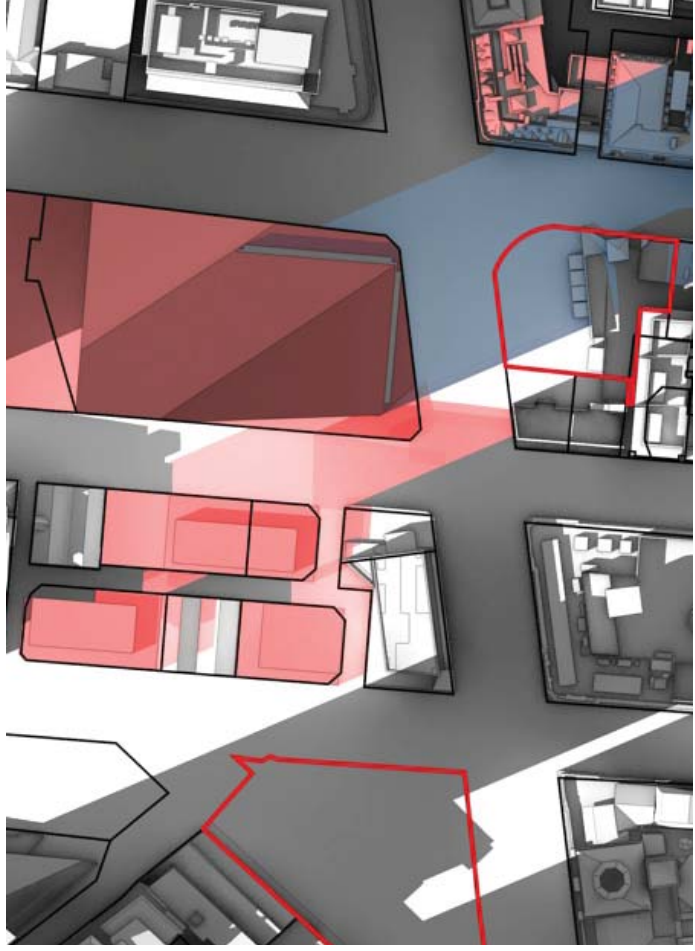
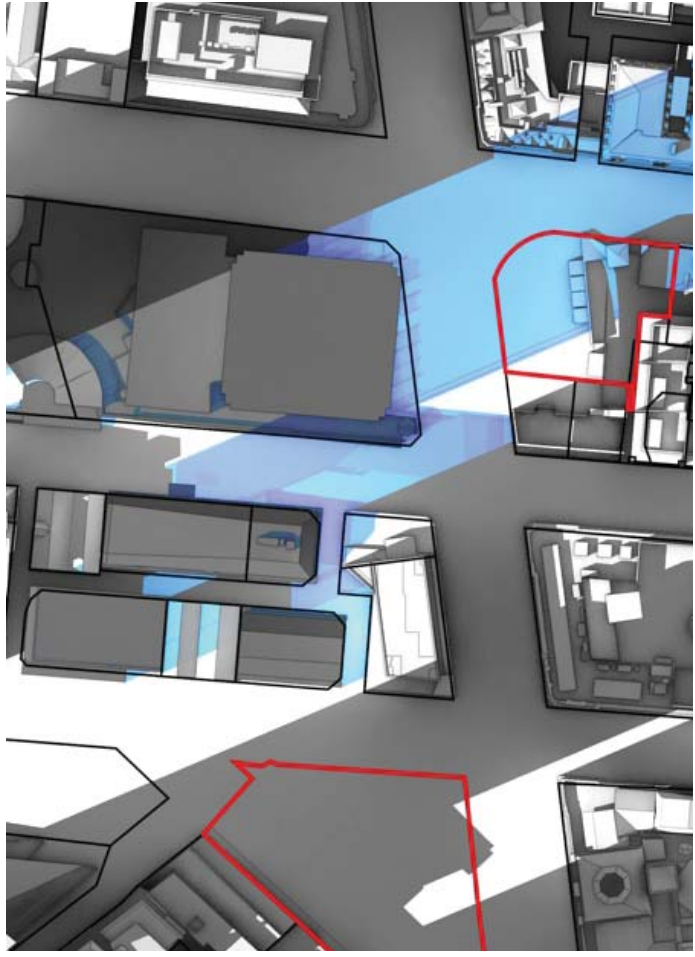

Legend

- Existing situation
- Proposed envelope



Time 01:20 pm

Date 21 June

Shadow and Sun Access Study

First Government House Place

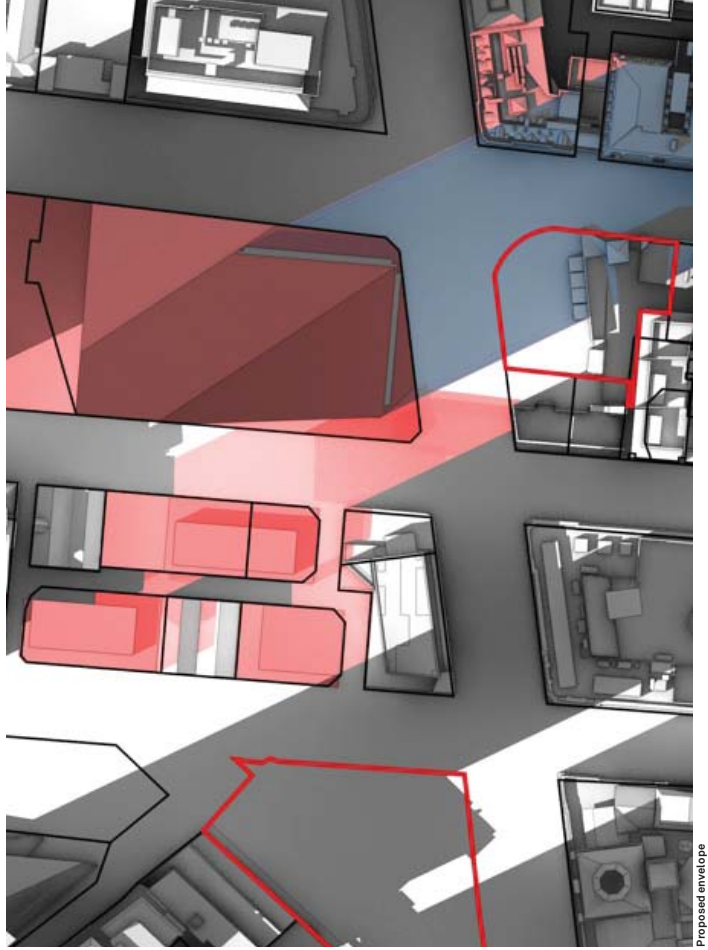
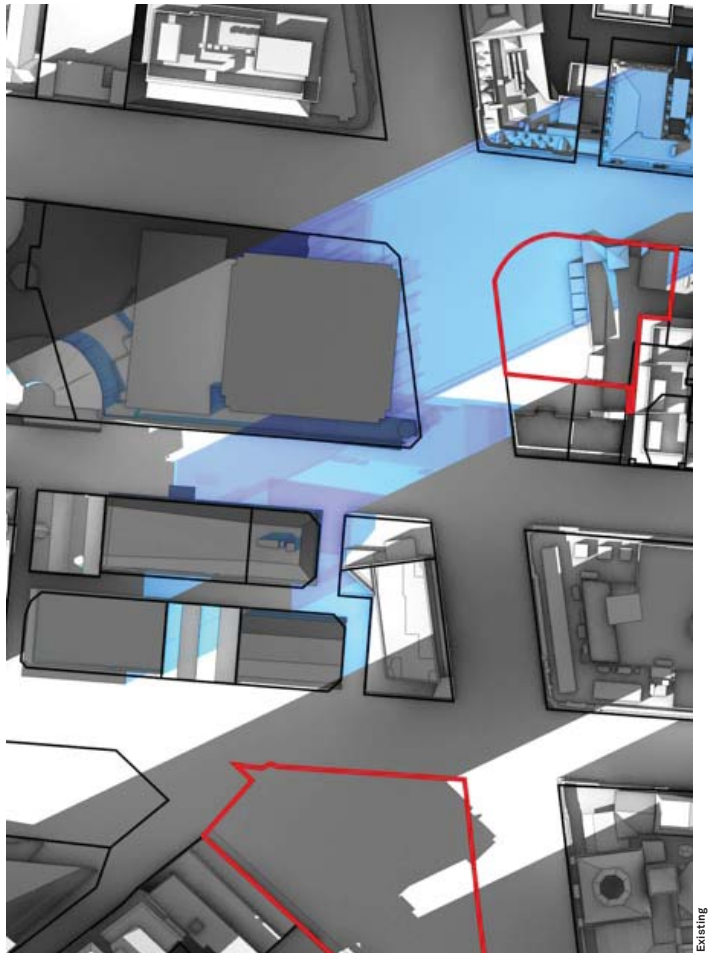

Legend

- Existing situation
- Proposed envelope



Time 01:30 pm

Date 21 June



Shadow and Sun Access Study

First Government House Place

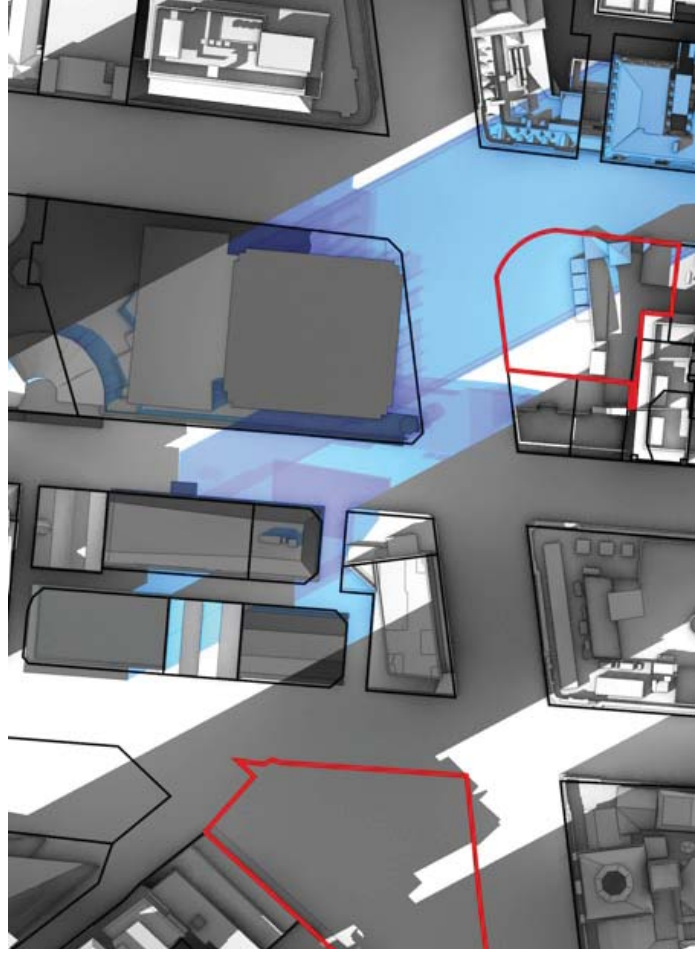

Existing

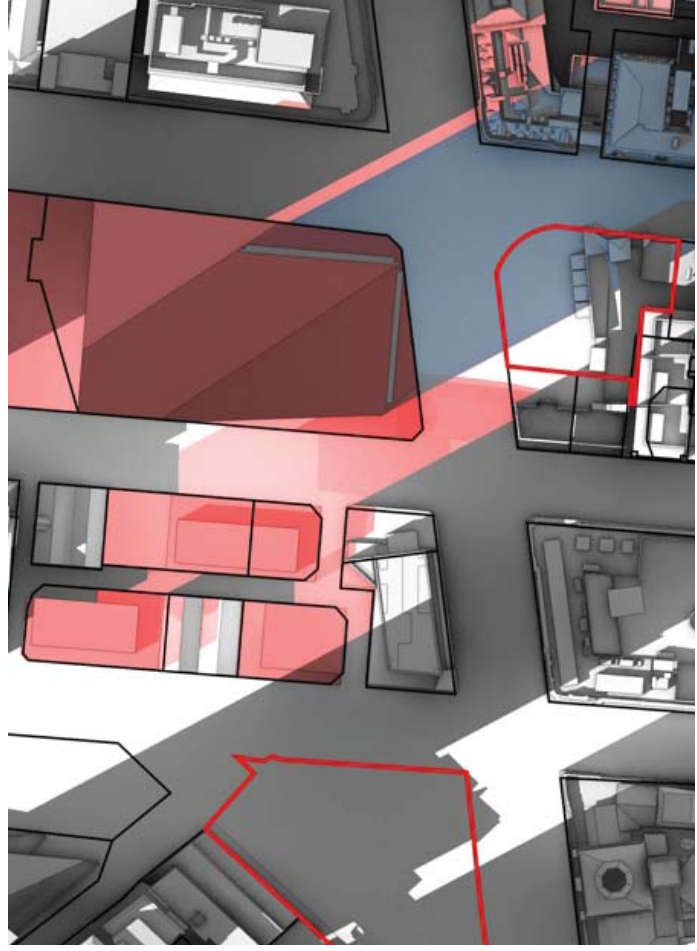

Proposed envelope

Legend

- Existing situation
- Proposed envelope



Time 01:40 pm

Date 21 June

Shadow and Sun Access Study

First Government House Place

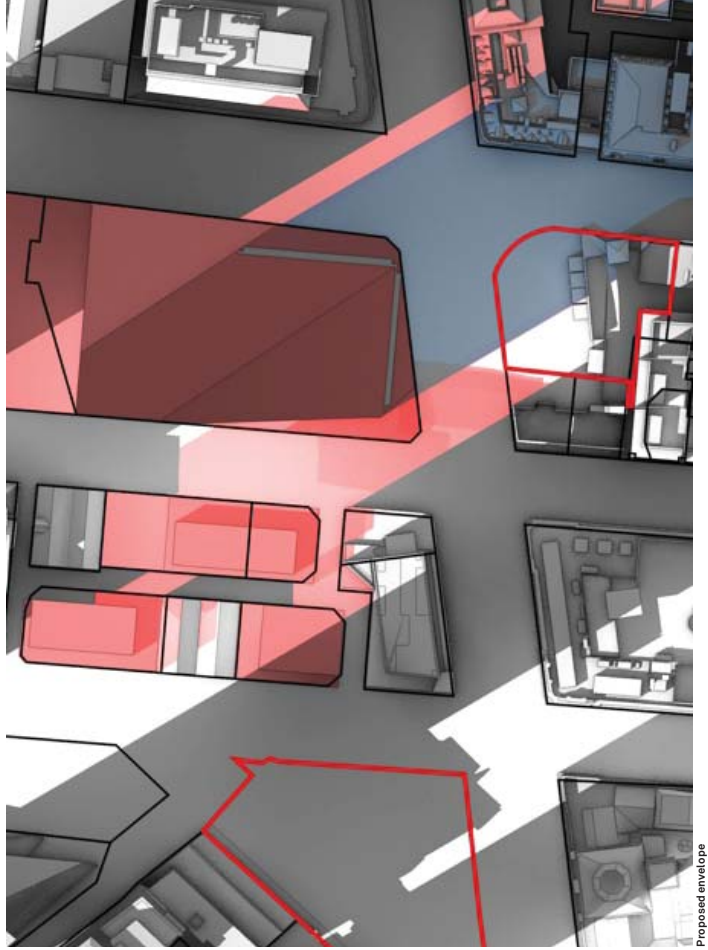
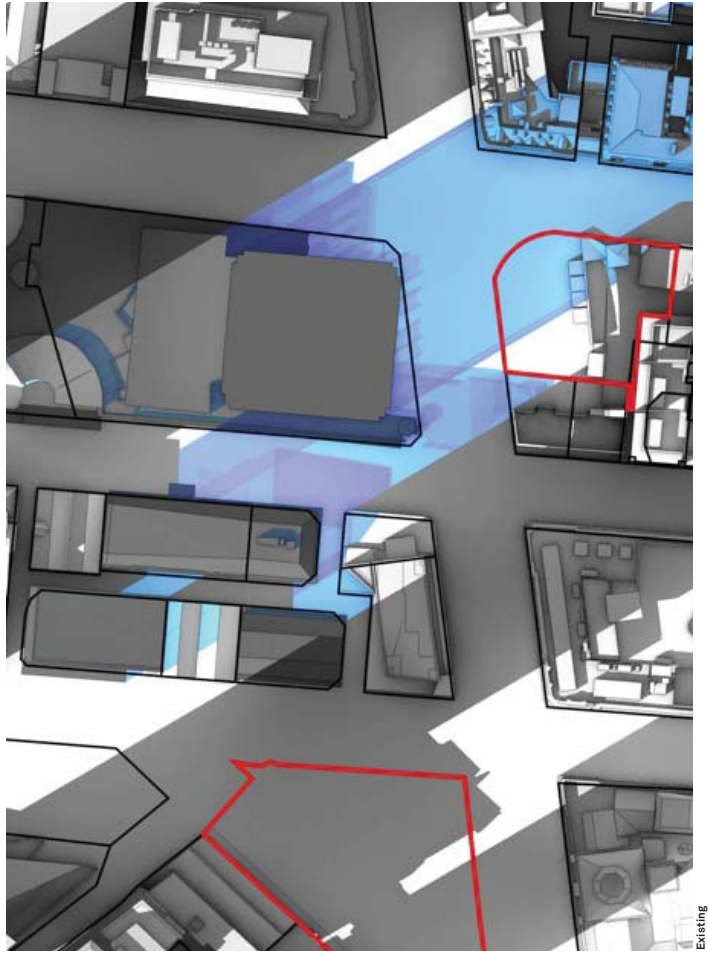

Legend

- Existing situation
- Proposed envelope



Time 01:50 pm

Date 21 June

Shadow and Sun Access Study

First Government House Place

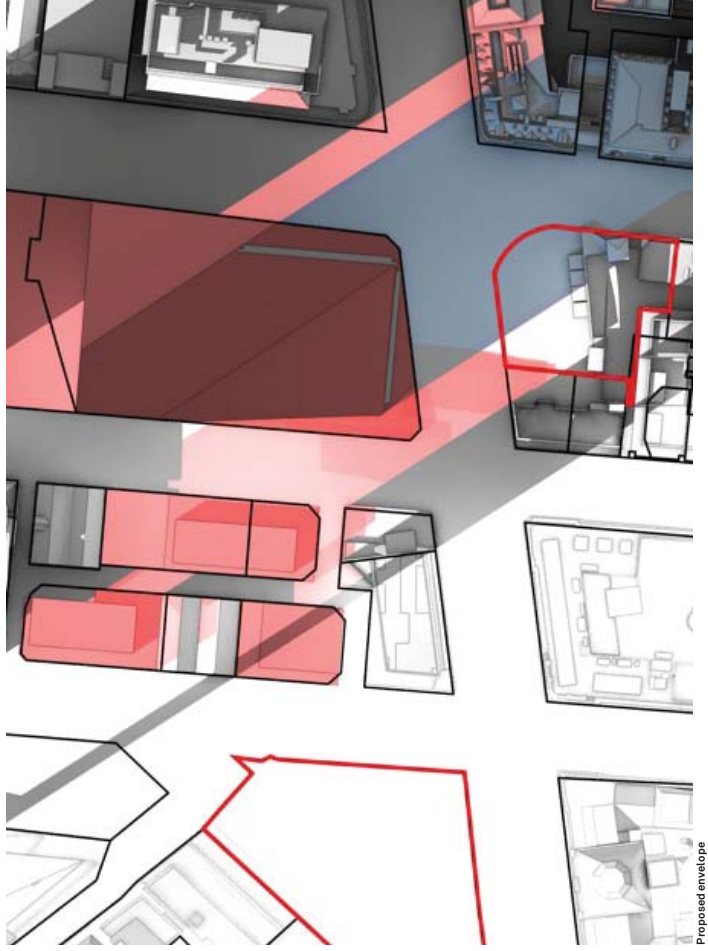
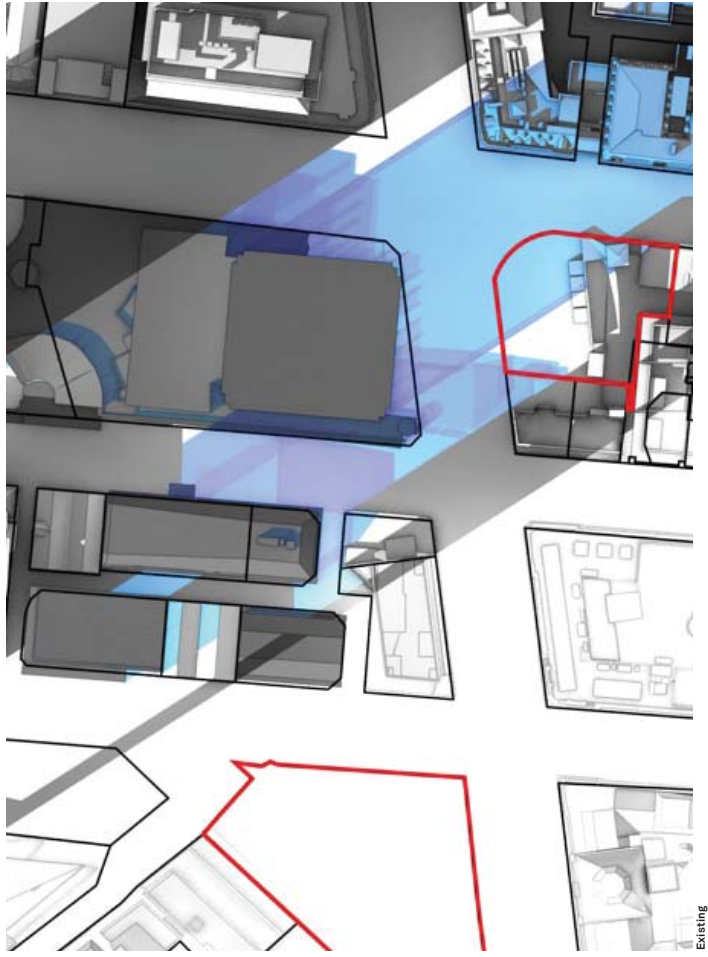

Legend

- Existing situation
- Proposed envelope



Time 02:30 pm

Date 21 June



31 August



Shadow and Sun Access Study

First Government House Place

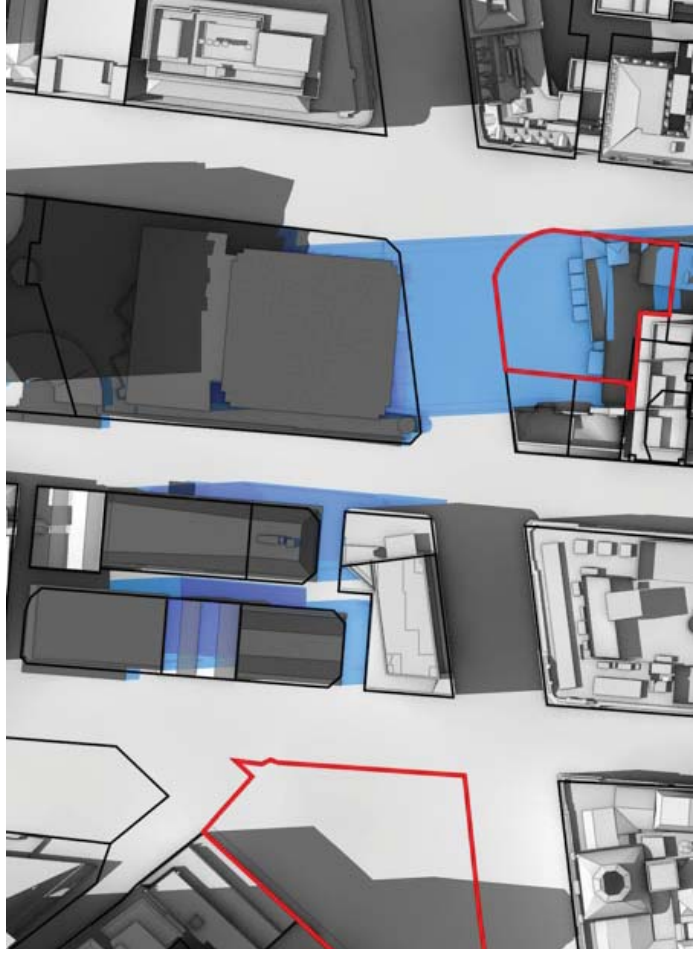

Existing

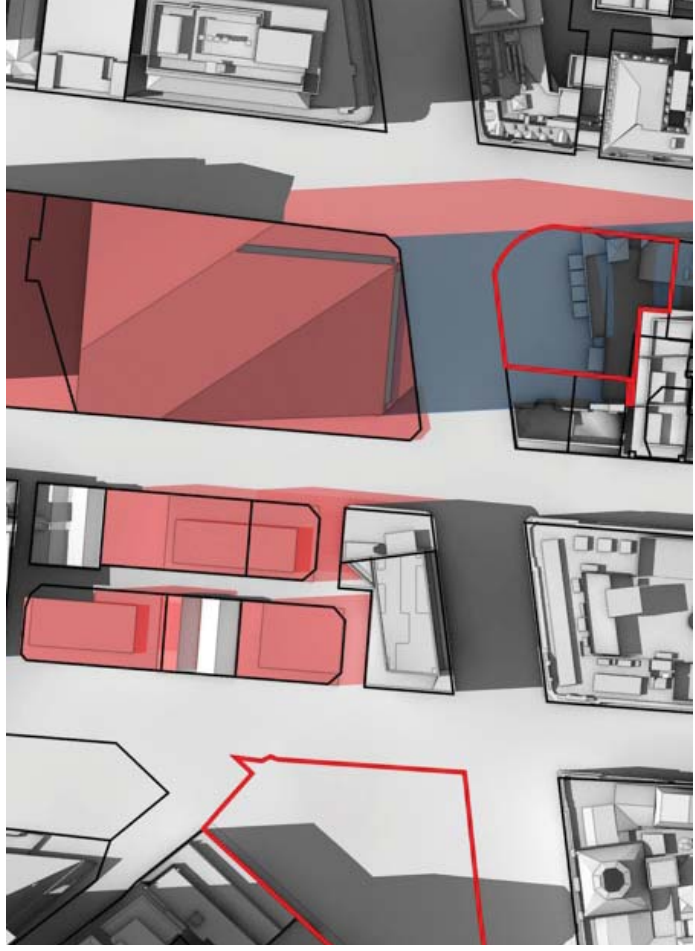

Proposed envelope

Legend

- Existing situation
- Proposed envelope



Time 12:00 pm

Date 31 August

Shadow and Sun Access Study

First Government House Place



Legend

- Existing situation
- Proposed envelope



Time  
12:10 pm

Date  
31 August



Shadow and Sun Access Study

First Government House Place



Legend

- Existing situation
- Proposed envelope



Time 12:20 pm

Date 31 August

Shadow and Sun Access Study

First Government House Place

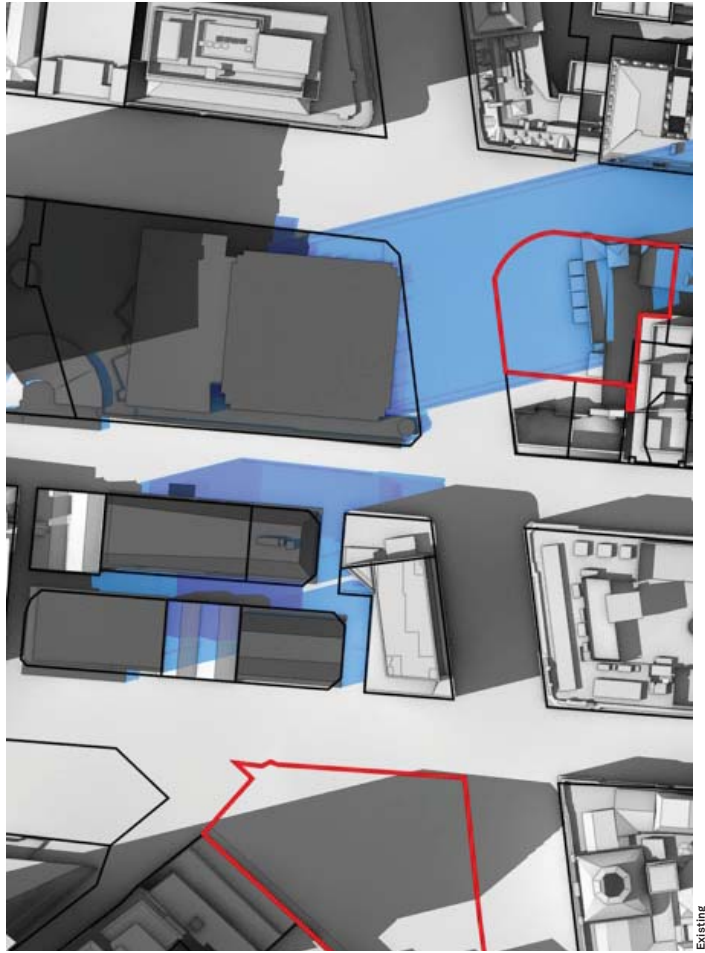

Existing



Proposed envelope

Legend

- Existing situation
- Proposed envelope



Time  
12:30 pm

Date  
31 August

Shadow and Sun Access Study

First Government House Place

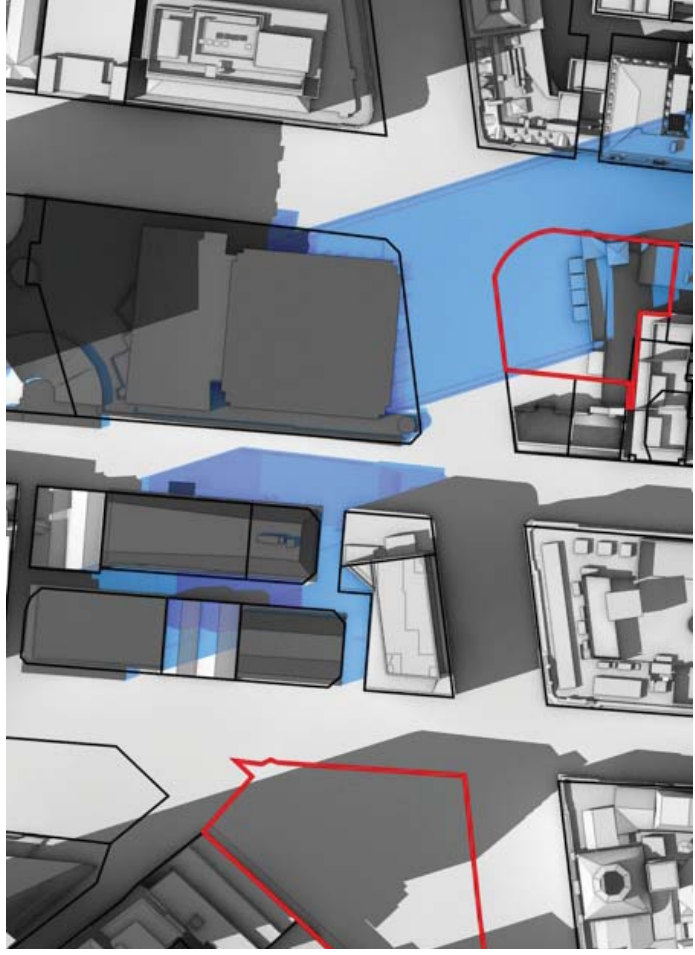

Existing

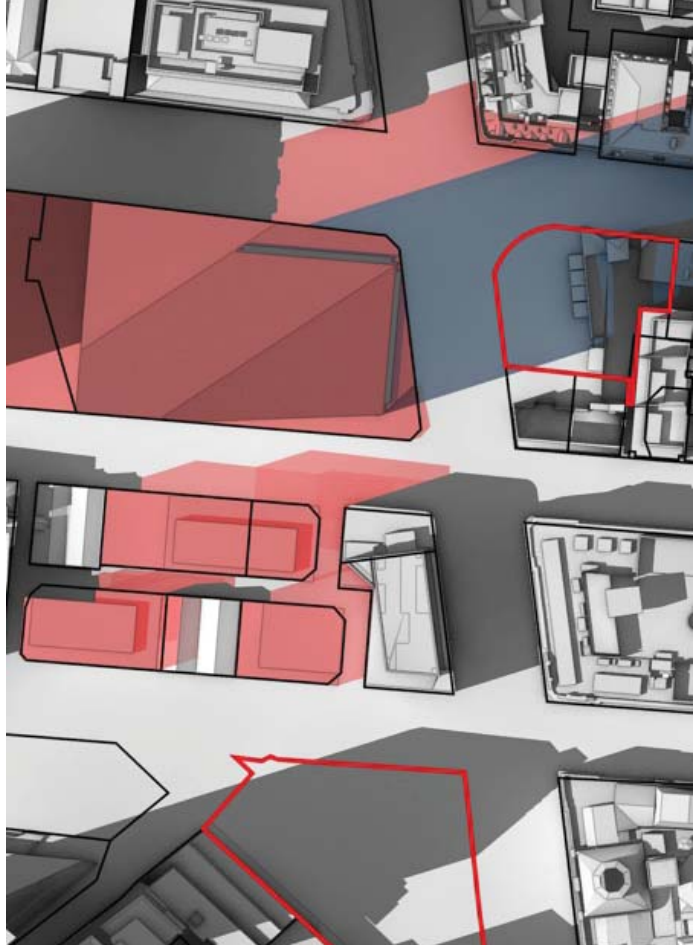

Proposed envelope

Legend

- Existing situation
- Proposed envelope



Time 12:40 pm

Date 31 August

Shadow and Sun Access Study

First Government House Place

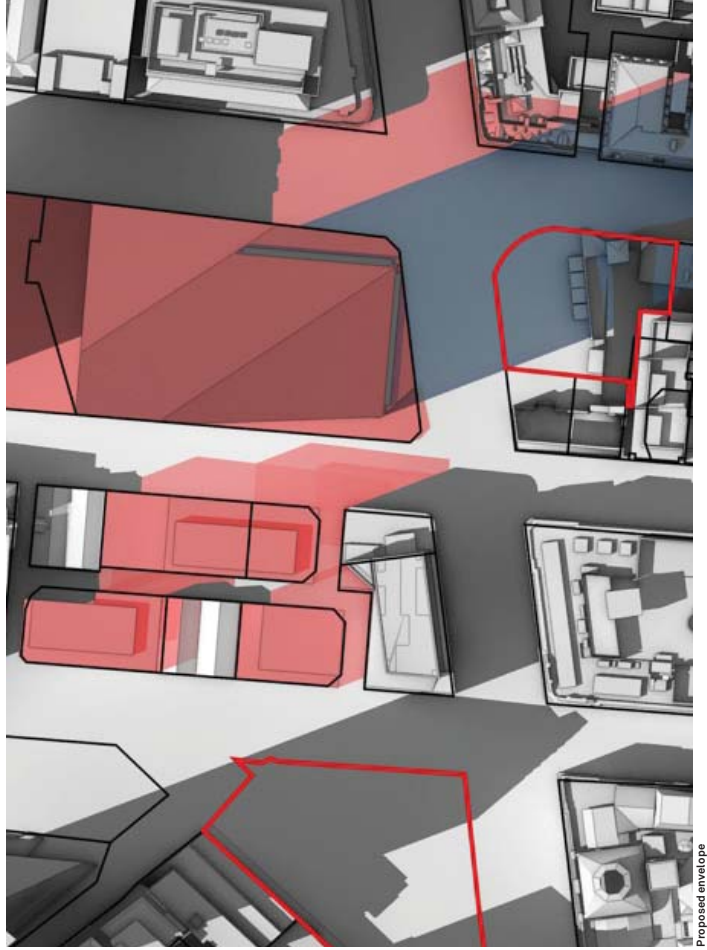
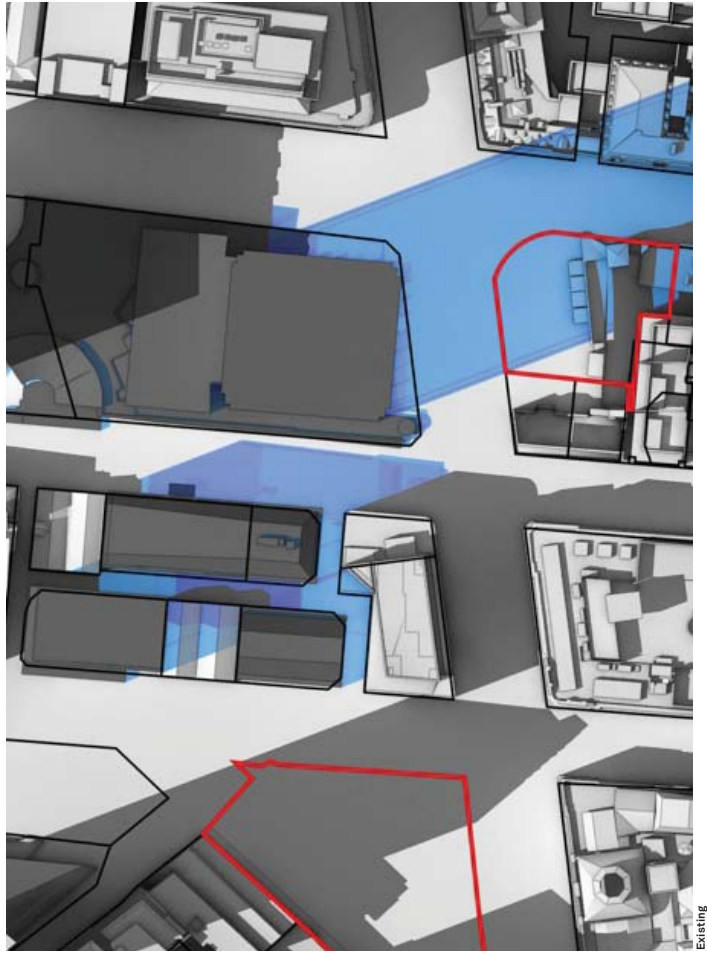

Legend

- Existing situation
- Proposed envelope



Time  
12:50 pm

Date  
31 August

Shadow and Sun Access Study

First Government House Place

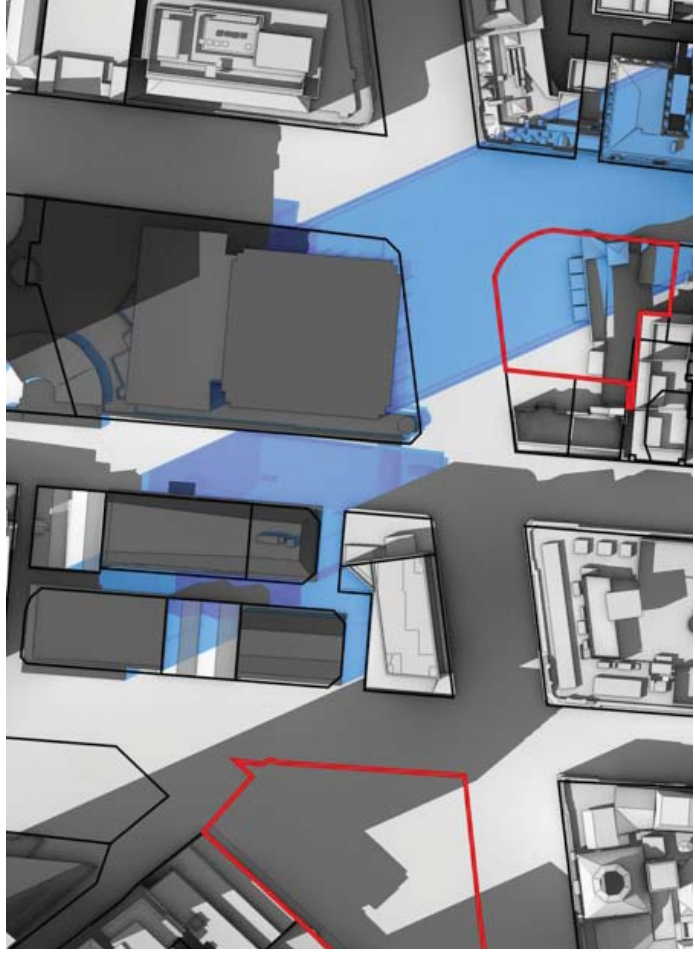

Existing

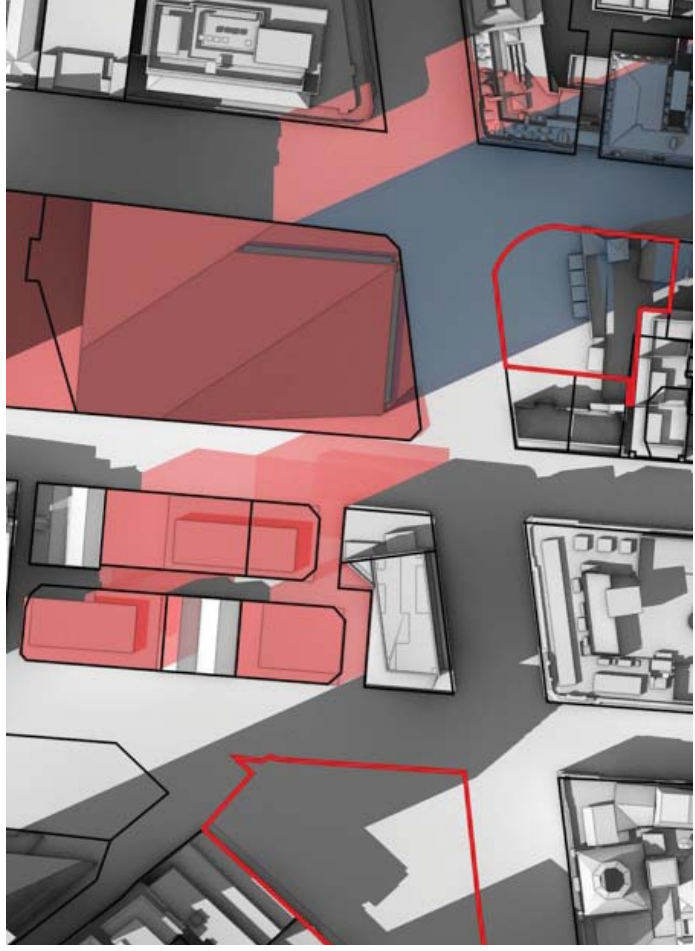

Proposed envelope

Legend

- Existing situation
- Proposed envelope



Time 01:00 pm

Date 31 August

Shadow and Sun Access Study

First Government House Place

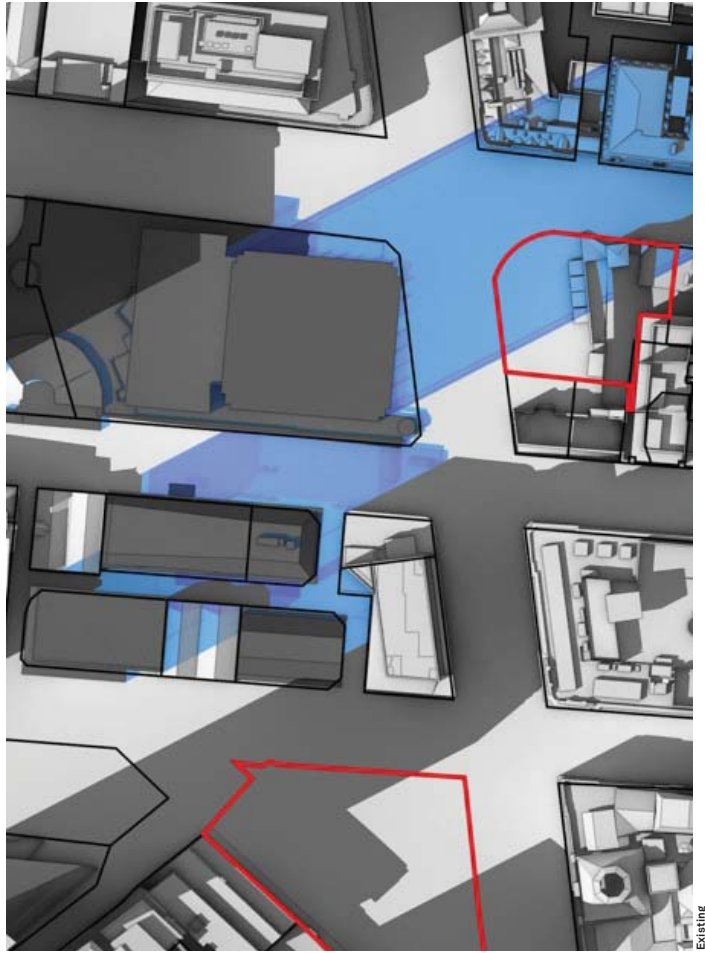

Existing

Legend

- Existing situation
- Proposed envelope

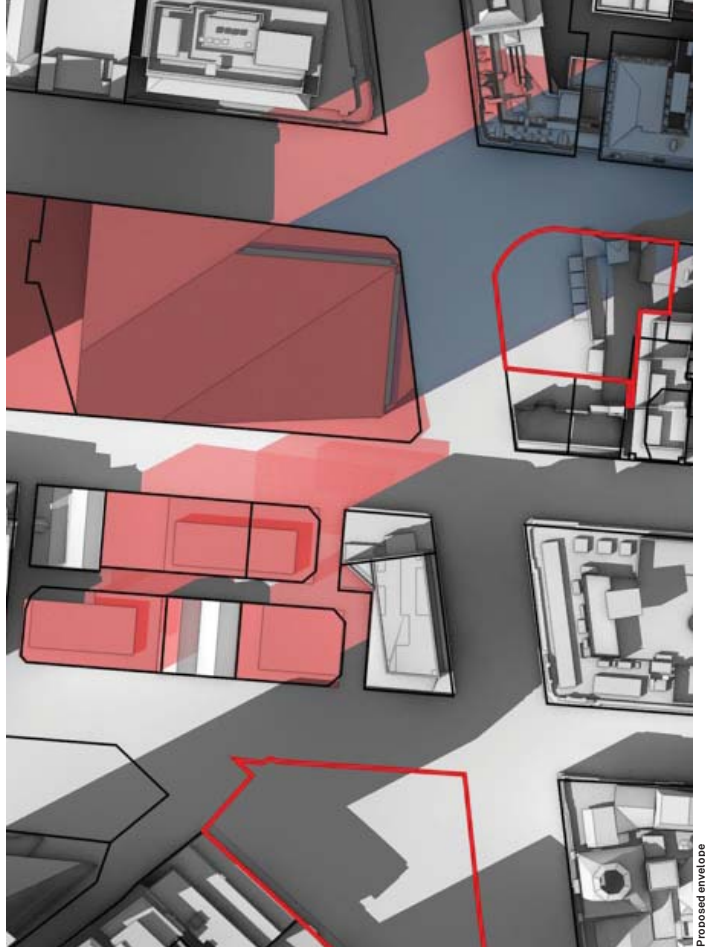

Proposed envelope



Time  
01:10 pm

Date  
31 August

Shadow and Sun Access Study

First Government House Place

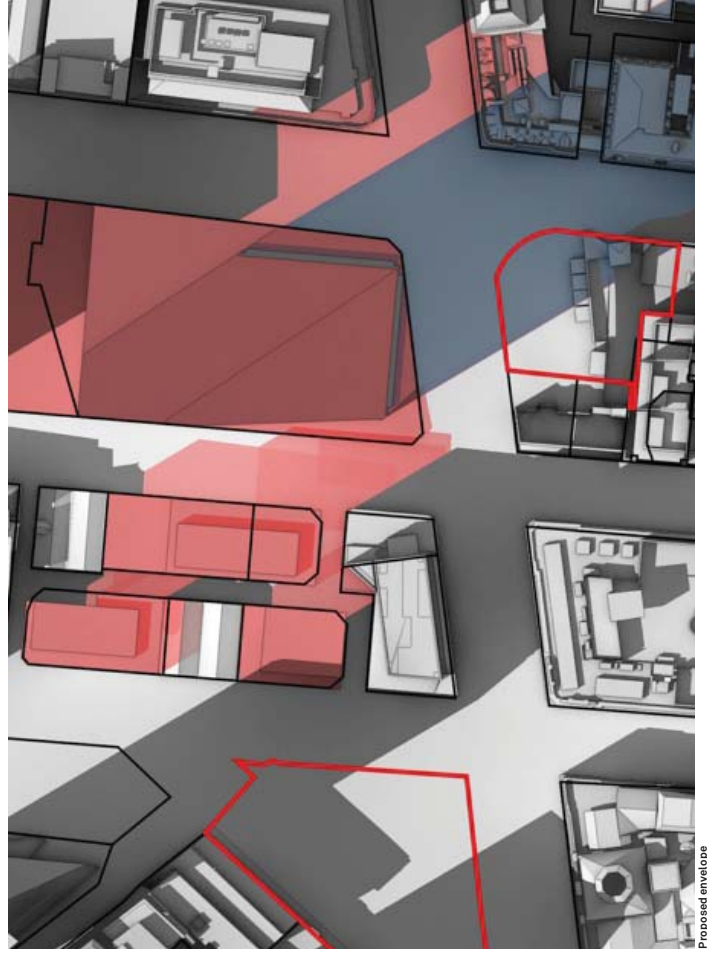
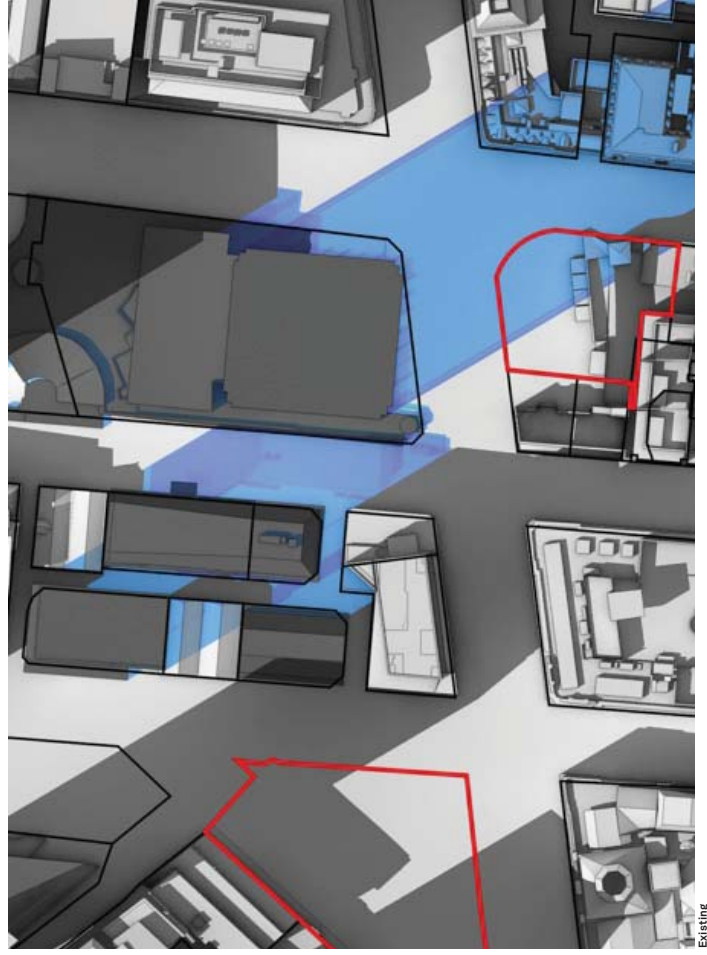

Legend

- Existing situation
- Proposed envelope



Time 01:20 pm

Date 31 August

Shadow and Sun Access Study

First Government House Place

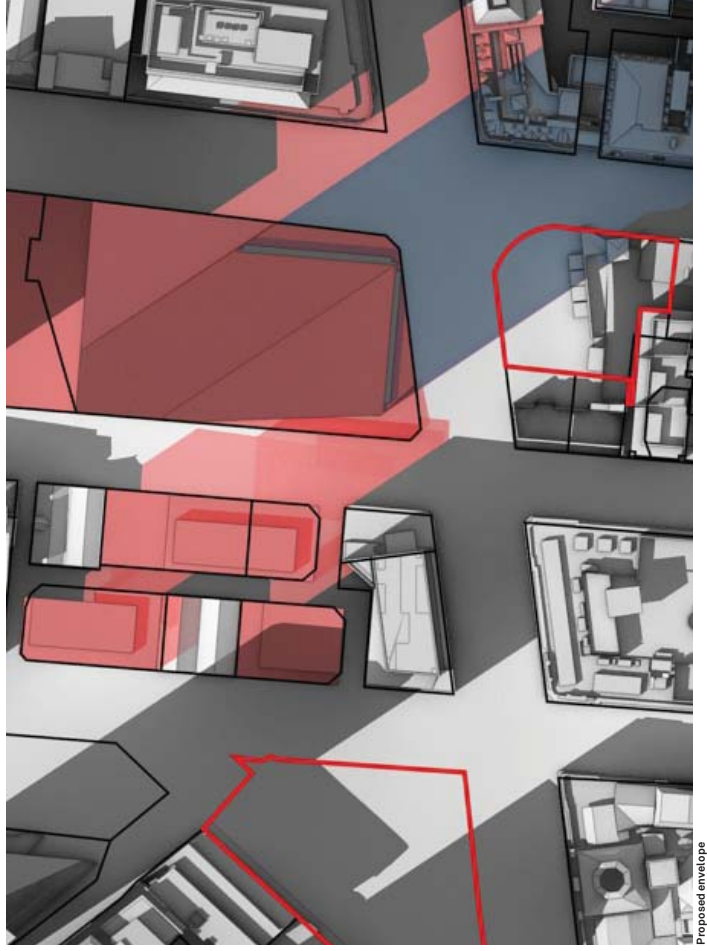
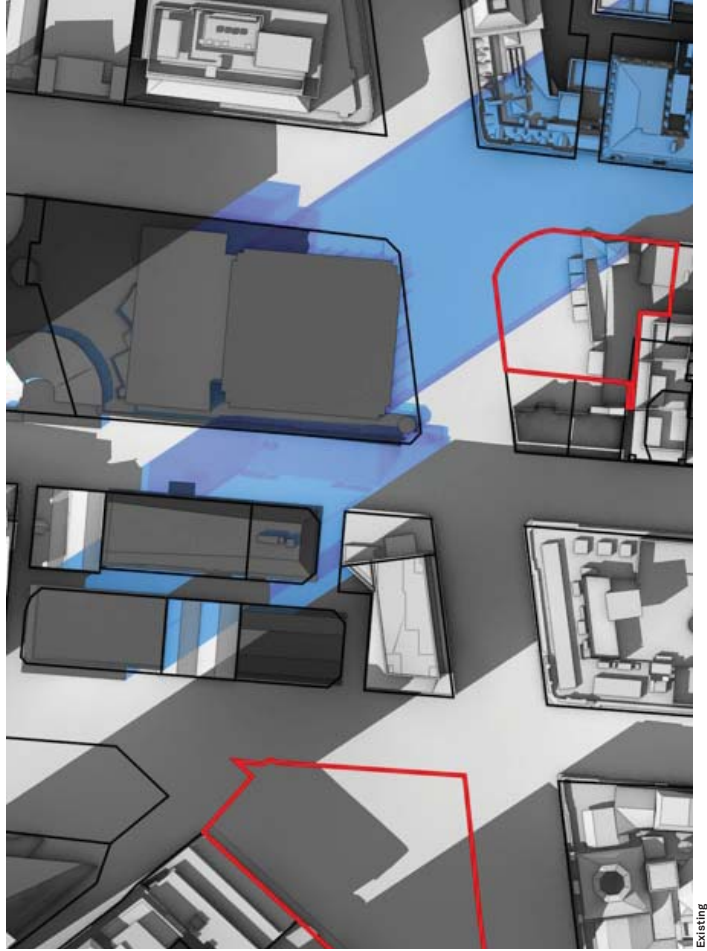

Legend

- Existing situation
- Proposed envelope



Time  
01:30 pm

Date  
31 August



Shadow and Sun Access Study

First Government House Place

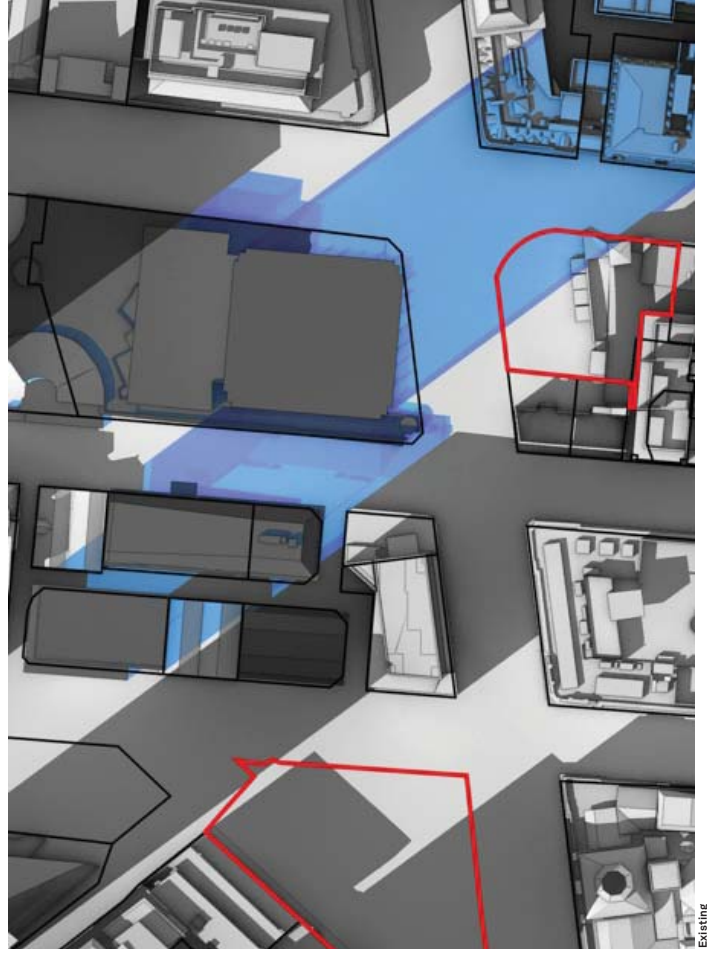

Legend

- Existing situation
- Proposed envelope

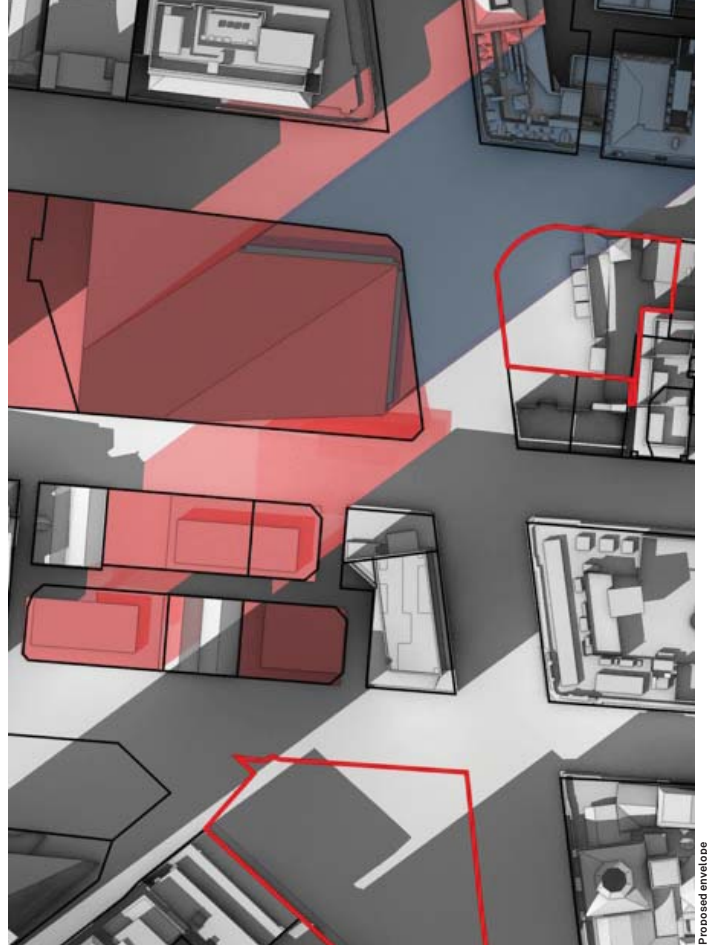

Time 01:40 pm

Date 31 August

Shadow and Sun Access Study

First Government House Place

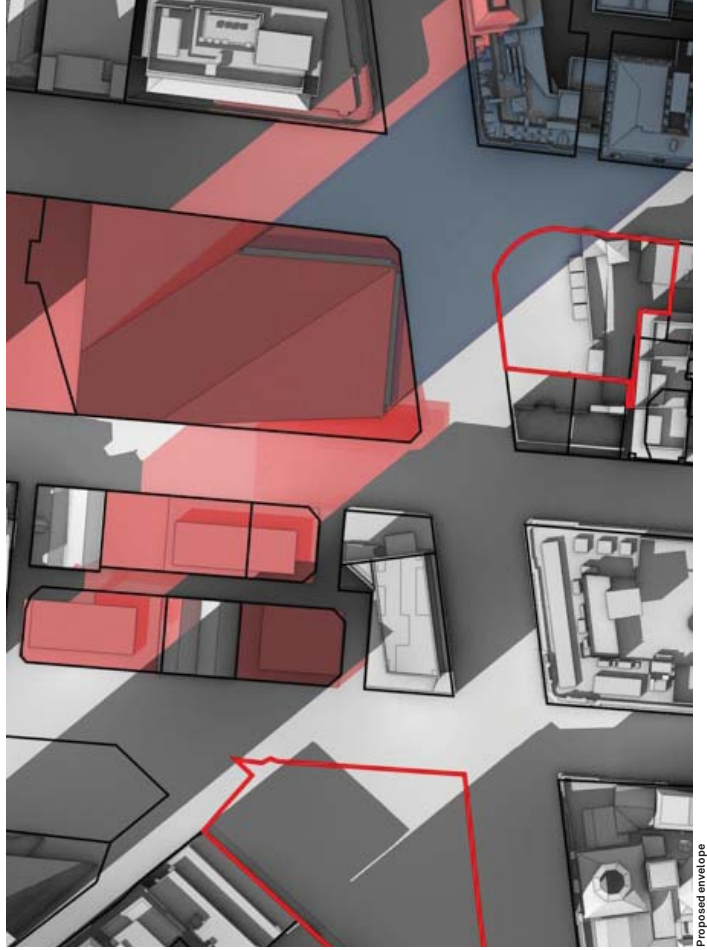
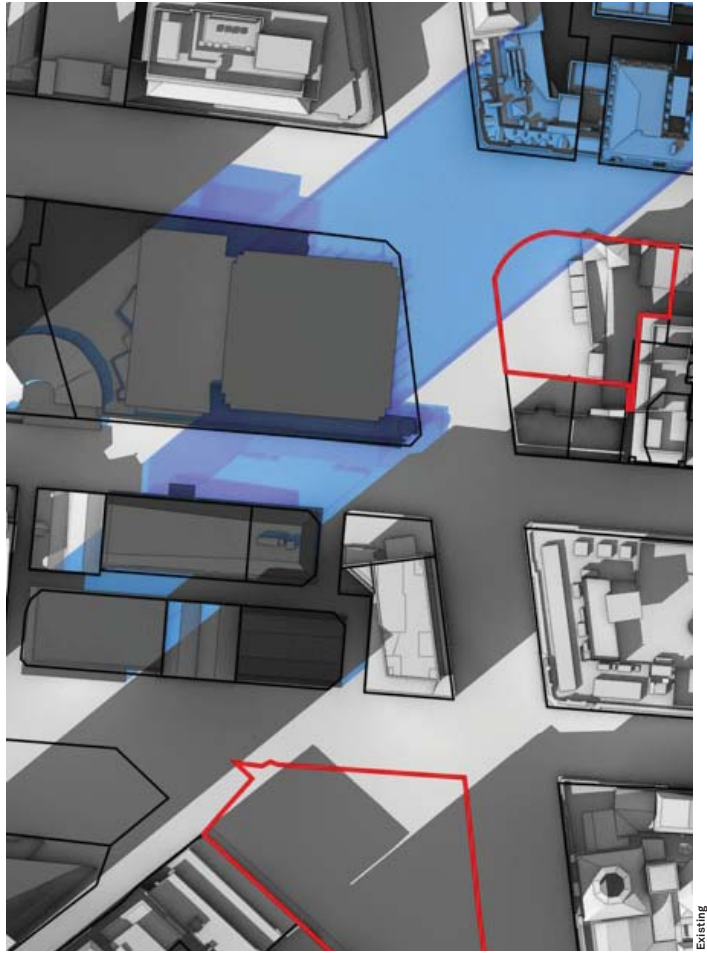

Legend

- Existing situation
- Proposed envelope



Time  
01:50 pm

Date  
31 August

Shadow and Sun Access Study

First Government House Place

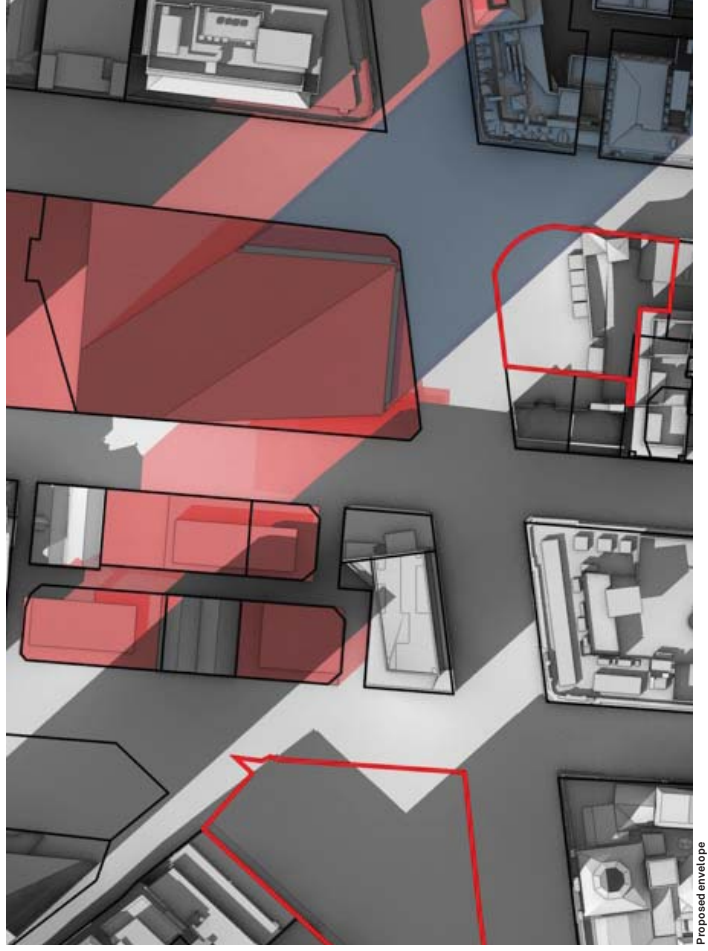
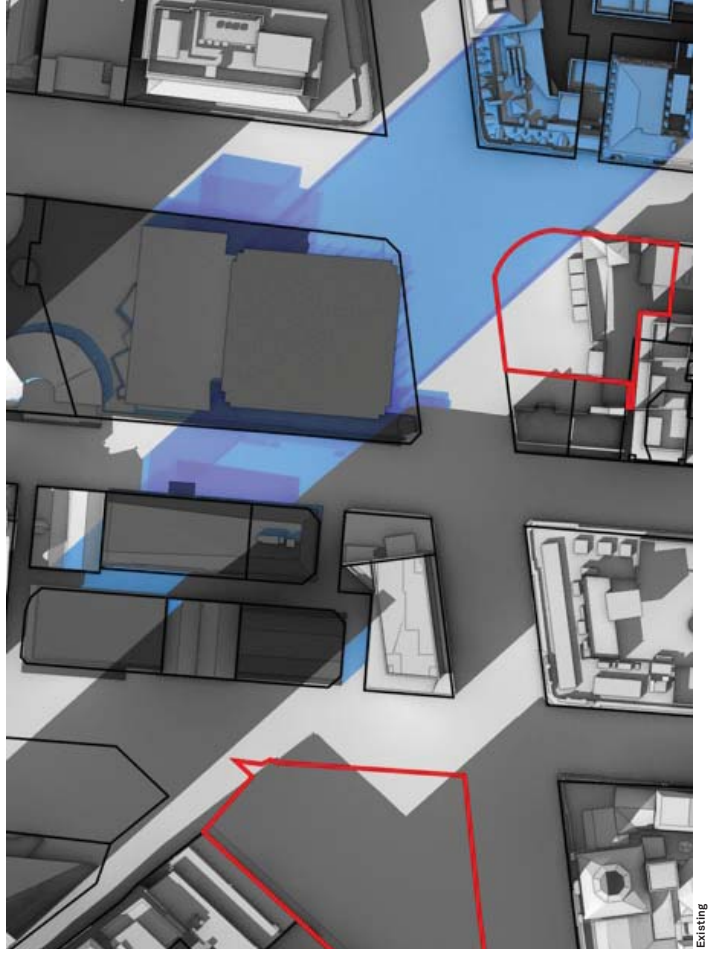

Legend

- Existing situation
- Proposed envelope



Time 02:30 pm

Date 31 August

## Australia

### Adelaide

HASSELL  
Level 15  
70 Hindmarsh Square  
Adelaide SA  
Australia 5000  
T +61 8 8220 5000  
E [adelaide@hasselstudio.com](mailto:adelaide@hasselstudio.com)

### Brisbane

HASSELL  
36 Warry Street  
Fortitude Valley QLD  
Australia 4006  
T +61 7 3914 4000  
E [brisbane@hasselstudio.com](mailto:brisbane@hasselstudio.com)

### Melbourne

HASSELL  
61 Little Collins Street  
Melbourne VIC  
Australia 3000  
T +61 3 8102 3000  
E [melbourne@hasselstudio.com](mailto:melbourne@hasselstudio.com)

### Perth

HASSELL  
Podium Level, Central Park  
152 – 158 St Georges Terrace  
Perth WA  
Australia 6000  
T +61 8 6477 6000  
E [perth@hasselstudio.com](mailto:perth@hasselstudio.com)

### Sydney

HASSELL  
Level 2  
88 Cumberland Street  
Sydney NSW  
Australia 2000  
T +61 2 9101 2000  
E [sydney@hasselstudio.com](mailto:sydney@hasselstudio.com)

## China

### Beijing

HASSELL  
Building A7  
50 Anjiatou  
Chaoyang District  
Beijing 100125 China  
T +8610 5126 6908  
E [beijing@hasselstudio.com](mailto:beijing@hasselstudio.com)

### Chongqing

HASSELL  
28F, International Trade Centre  
38 Qing Nian Road  
Yu Zhong District  
Chongqing 400010 China  
T +8623 6310 6888  
E [chongqing@hasselstudio.com](mailto:chongqing@hasselstudio.com)

### Hong Kong SAR

HASSELL  
22F, 169 Electric Road  
North Point Hong Kong SAR  
T +852 2552 9098  
E [hongkong@hasselstudio.com](mailto:hongkong@hasselstudio.com)

### Shanghai

HASSELL  
Building 8 Xing Fu Ma Tou  
1029 South Zhongshan Road  
Huangpu District  
Shanghai 200011 China  
T +8621 6887 8777  
E [shanghai@hasselstudio.com](mailto:shanghai@hasselstudio.com)

### Shenzhen

HASSELL  
37F, Landmark  
4028 Jintian Road  
Futian District  
Shenzhen 518035 China  
T +86755 2381 1838  
E [shenzhen@hasselstudio.com](mailto:shenzhen@hasselstudio.com)

## South East Asia

### Bangkok

HASSELL  
18F, K Tower  
209 Sukhumvit Soi 21  
Klongtoey-Nua Wattana  
Bangkok 10110 Thailand  
T +66 2207 8999  
E [bangkok@hasselstudio.com](mailto:bangkok@hasselstudio.com)

### Singapore

HASSELL  
17A Stanley Street  
068736 Singapore  
T +65 6224 4688  
E [singapore@hasselstudio.com](mailto:singapore@hasselstudio.com)

## United Kingdom

### Cardiff

HASSELL  
4th Floor, James William House  
9 Museum Place  
Cardiff CF10 3BD United Kingdom  
T +44 29 2072 9071  
E [cardiff@hasselstudio.com](mailto:cardiff@hasselstudio.com)

### London

HASSELL  
Level 2, Morelands  
17 – 21 Old Street  
Clerkenwell  
London EC1V 9HL United Kingdom  
T +44 20 7490 7689  
E [london@hasselstudio.com](mailto:london@hasselstudio.com)